

**E3TMLA30**

Single **T**imber Frame with Resilient **M**ount

**L**oad Bearing

Two Way **FRR**

**3** Layers: 1 Layer of Plasterboard on Framing side &  
2 Layers of Plasterboard on Mount side

Full Intertency **A**coustic

System Number	Lining Suffix	Fire Rating	Load Bearing Ability	Noise Control		Lining Requirement
				STC	Rw	
<b>E3TMLA30</b>	<b>-S39</b>	30/30/30	LB	55	54	Framing Side: 1 x 13mm Elephant Standard Mount Side: 2 x 13mm Elephant Standard
	<b>-M30</b>	30/30/30	LB	56	55	Framing Side: 1 x 10mm Elephant MultiSmart Mount Side: 2 x 10mm Elephant MultiSmart

**Framing**

Framing to comply with relevant sections and clauses of NZBC B1: Structure and NZBC B2: Durability.  
Studs at 600mm centres maximum.  
Nogs at 1350mm centre maximum.

**Wall Height, Load and Framing Dimension**

These are determined by NZS3604 stud tables for load bearing or non-load bearing partitions. Minimum 90 x 45mm frame dimension.

**Minimum Partition Width**

In order to achieve the STC ratings in the table above the partition width (excluding the board) shall be a minimum of 130mm.

Stud Depth	Mount + Channel	Lining Suffix	Total Plasterboard thickness	Total Partition Width
90mm	40mm	M30	30mm	160mm
		S39	39mm	169mm

**Wall Sound Absorber**

Install Sound Absorber between studs and nogs of the frame.  
Use 90mm thick R2.2 glass wool insulation.

**Acoustic Resilient Mount**

The Resilient Mount shall be fixed to the studs at 600mm centres vertically and on every alternative stud using 32mm x 8g wafer head screws. When adjusting the clip for depth, 3mm rubber must remain between the underside of the steel spacer head and the furring channel. The Furring channels are clipped horizontally into the Mounts. Joints must be made as close as possible to the clips.

**Plasterboard Lining**

One layer of Elephant Plasterboard lining fixed vertically on framing side and Two layers fixed vertically on the furring channel on the other side as per specified system above.

Vertical fixing only permitted. Vertical joints of outer layer should be offset by 600mm from those of the inner layer. Use full height sheets where possible. All sheet joints on the framing side must be fixed over solid timber framing. Sheet end butt joints must be formed over nogs or furring channels and offset the outer layer joints from the inner layer. Sheets shall be touch fitted.

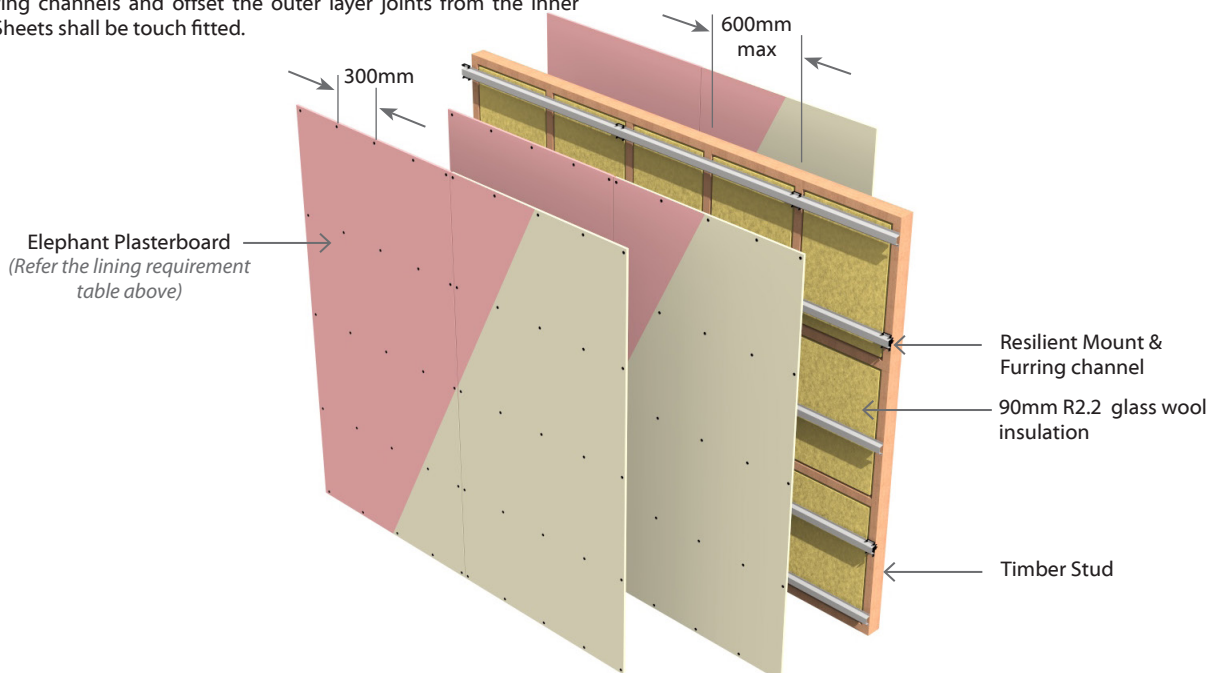

**Fixing of Linings**

**Fasteners (As per Specified System Above)**

System Number	Furring Channel Side		Framing Side
	1 <sup>st</sup> Layer	2 <sup>nd</sup> Layer	Single Layer
<b>E3TMLA30-M30</b>	Self-Tapping Drywall Screws		High Thread Drywall Screws
	10mm	10mm	13mm
<b>E3TMLA30-S39</b>	41 x 6g	51 x 7g	41 x 6g
	13mm	13mm	13mm
	41 x 6g	51 x 7g	41 x 6g

**Fastener Centres**

**Framing Side:** Fix at 300mm centres at sheet perimeter and up each stud.

**Resilient Mount Side:** Fix 300mm centres along each furring channel. Place fasteners minimum 12mm from sheet edges and sheet ends. Place fasteners at 200mm centres where sheet end butt joints occur. Avoid outer layer screws from hitting inner layer screws.

**Acoustic Sealant**

A bead of acoustic sealant is required around the perimeter of the framing or the inner layer. The single or outer layer is then bedded onto the bead. The perimeter junctions of the wall must be airtight.

**Jointing**

Inner Layer: Unstopped.

Outer or Single Layer: All fastener heads stopped and all sheet joints reinforced and stopped. Wall to ceiling junctions are to be reinforced with paper tape and square stopped or finished with Cornice. All in accordance with Elephant Plasterboard Installation Guide.

