

EUROSTYLE SPANLOK™ VARIABLE PAN ROOFING ON PURLINS

RESIDENTIAL SPANLOK SHEET LIST

Detail Number: RI-ESVPRRPUR-000A

Date drawn: 20/05/2024

Scale: @ A4

Residential Spanlok Roofing Sheet List on Purlin		
Sheet Number	Type	Sheet Name
EUROSTYLE SPANLOK™		
RI-ESVPRRPUR-000A	EUROSTYLE SPANLOK™ VARIABLE PAN ROOFING ON PURLINS	RESIDENTIAL SPANLOK SHEET LIST
RI-ESVPRRPUR-000B	EUROSTYLE SPANLOK™ VARIABLE PAN ROOFING ON PURLINS	PROFILES & ACCESSORIES
RI-ESVPRRPUR-000C	EUROSTYLE SPANLOK™ VARIABLE PAN ROOFING ON PURLINS	PROFILE SUMMARY - SPANLOK™
RI-ESVPRRPUR-000D	EUROSTYLE SPANLOK™ VARIABLE PAN ROOFING ON PURLINS	ROLL CAP
RI-ESVPRRPUR-030A	EUROSTYLE SPANLOK™ VARIABLE PAN ROOFING ON PURLINS	BARGE DETAIL (TYPE 1)
RI-ESVPRRPUR-030B	EUROSTYLE SPANLOK™ VARIABLE PAN ROOFING ON PURLINS	BARGE DETAIL (TYPE 2)
RI-ESVPRRPUR-030C	EUROSTYLE SPANLOK™ VARIABLE PAN ROOFING ON PURLINS	BARGE DETAIL (TYPE 3)
RI-ESVPRRPUR-040	EUROSTYLE SPANLOK™ VARIABLE PAN ROOFING ON PURLINS	TYPICAL HEAD BARGE DETAIL
RI-ESVPRRPUR-050	EUROSTYLE SPANLOK™ VARIABLE PAN ROOFING ON PURLINS	TYPICAL CHANGE IN PITCH
RI-ESVPRRPUR-050B	EUROSTYLE SPANLOK™ VARIABLE PAN ROOFING ON PURLINS	MANSARD / EXTERNAL CHANGE IN PITCH FLASHING
RI-ESVPRRPUR-060A	EUROSTYLE SPANLOK™ VARIABLE PAN ROOFING ON PURLINS	GUTTER APRON DETAIL
RI-ESVPRRPUR-060C	EUROSTYLE SPANLOK™ VARIABLE PAN ROOFING ON PURLINS	GUTTER APRON DETAIL (NO SOFFIT)
RI-ESVPRRPUR-070A	EUROSTYLE SPANLOK™ VARIABLE PAN ROOFING ON PURLINS	VENTILATED RIDGE AND HIP DETAIL

Residential Spanlok Roofing Sheet List on Purlin		
Sheet Number	Type	Sheet Name
RI-ESVPRRPUR-070B	EUROSTYLE SPANLOK™ VARIABLE PAN ROOFING ON PURLINS	BARGE & RIDGE UNDER FLASHINGS
RI-ESVPRRPUR-080A	EUROSTYLE SPANLOK™ VARIABLE PAN ROOFING ON PURLINS	TYPICAL VALLEY DETAIL
RI-ESVPRRPUR-080B	EUROSTYLE SPANLOK™ VARIABLE PAN ROOFING ON PURLINS	DORMER VALLEY DETAIL
RI-ESVPRRPUR-090	EUROSTYLE SPANLOK™ VARIABLE PAN ROOFING ON PURLINS	INTERNAL GUTTER
RI-ESVPRRPUR-110A	EUROSTYLE SPANLOK™ VARIABLE PAN ROOFING ON PURLINS	PARALLEL APRON FLASHING (NON CAVITY) TYPE 1, OPTION 1
RI-ESVPRRPUR-110B	EUROSTYLE SPANLOK™ VARIABLE PAN ROOFING ON PURLINS	PARALLEL APRON FLASHING (NON CAVITY) TYPE 1, OPTION 2
RI-ESVPRRPUR-110C	EUROSTYLE SPANLOK™ VARIABLE PAN ROOFING ON PURLINS	PARALLEL APRON FLASHING (CAVITY) TYPE 1, OPTION 1
RI-ESVPRRPUR-110D	EUROSTYLE SPANLOK™ VARIABLE PAN ROOFING ON PURLINS	PARALLEL APRON FLASHING (CAVITY) TYPE 1, OPTION 2
RI-ESVPRRPUR-120A	EUROSTYLE SPANLOK™ VARIABLE PAN ROOFING ON PURLINS	TYPICAL APRON FLASHING (CAVITY) TYPE 1
RI-ESVPRRPUR-120B	EUROSTYLE SPANLOK™ VARIABLE PAN ROOFING ON PURLINS	TYPICAL APRON FLASHING (NON CAVITY) TYPE 1
RI-ESVPRRPUR-160A	EUROSTYLE SPANLOK™ VARIABLE PAN ROOFING ON PURLINS	PIPE PENETRATION 2 (MID PAN)
RI-ESVPRRPUR-160B	EUROSTYLE SPANLOK™ VARIABLE PAN ROOFING ON PURLINS	PIPE PENETRATION AT GUTTER EDGE
RI-ESVPRRPUR-190	EUROSTYLE SPANLOK™ VARIABLE PAN ROOFING ON PURLINS	PENETRATION FLASHING DETAILS

Copyright detail © 2024



EUROSTYLE SPANLOK™ VARIABLE PAN ROOFING ON PURLINS PROFILES & ACCESSORIES

Detail Number: RI-ESVPRRPUR-000B
Date drawn: 20/05/2024
Scale: 1 : 5@ A3

ROOFING INDUSTRIES EUROSTYLE SPANLOK™
SECRET CLIP FIXED

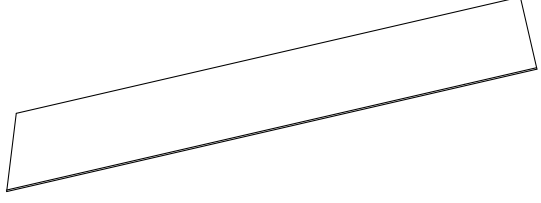

EUROSTYLE BARGE
FLASHING

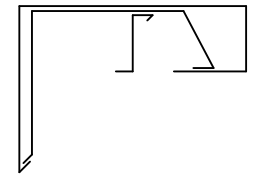

EUROSTYLE BARGE
FLASHING

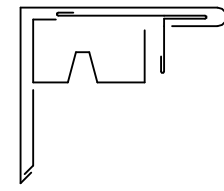

ROOFING INDUSTRIES
EUROSTYLE HEAD
BARGE FLASHING

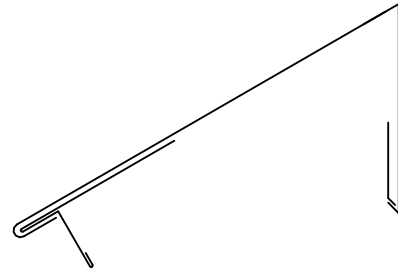

ROOFING INDUSTRIES
CHANGE IN PITCH
FLASHING

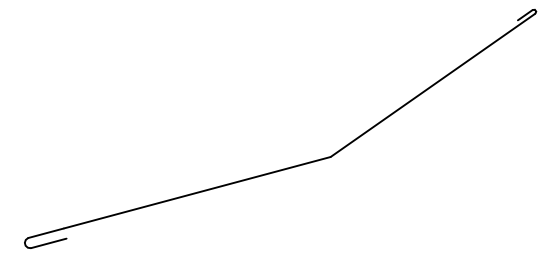

ROOFING INDUSTRIES EUROSTYLE SPANLOK™
SECRET CLIP FIXED

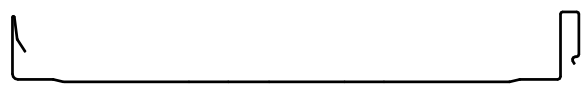

ROOFING INDUSTRIES
UNDERFLASHING

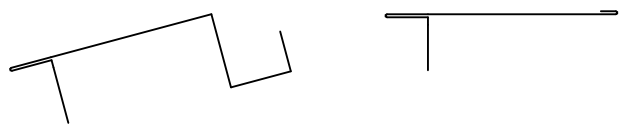

ROOFING INDUSTRIES
GUTTER APRON
FLASHING

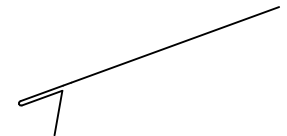

ROOFING INDUSTRIES
ANGLE FLASHING

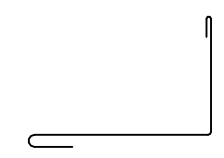

ROOFING INDUSTRIES
APRON FLASHING

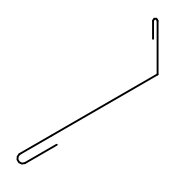

Fixings

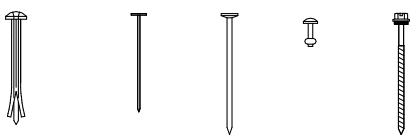

ROOFING INDUSTRIES
RIDGE FLASHING

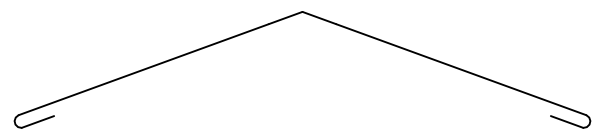

CAVITY CLOSER METAL ANGLE



ROOFING INDUSTRIES
VALLEY GUTTER

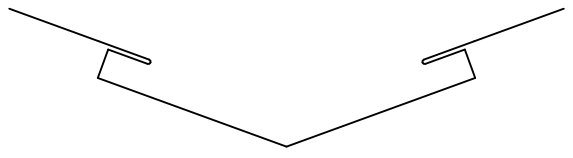

ROOFING INDUSTRIES
VALLEY GUTTER

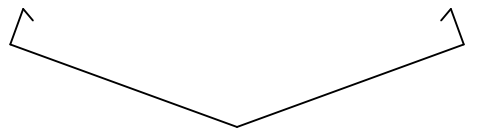

ROOFING INDUSTRIES
DORMER VALLEY
GUTTER

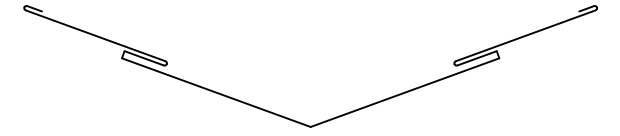

Copyright detail © 2024



EUROSTYLE SPANLOK™ VARIABLE PAN ROOFING ON PURLINS PROFILE SUMMARY - SPANLOK™

Detail Number: RI-ESVPRRPUR-000C

Date drawn: 20/05/2024

Scale: 1 : 5@ A4

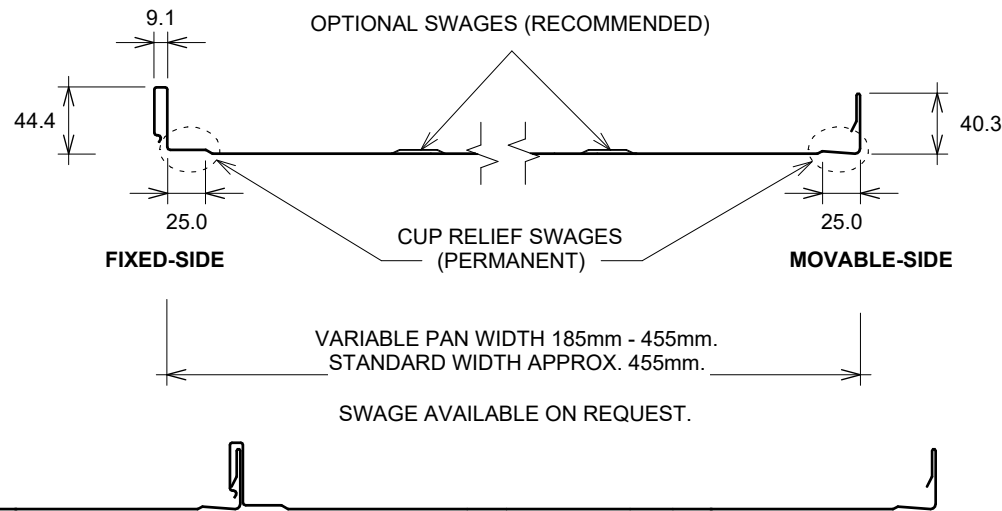

SPANLOK™

COIL SIZE	610mm	525mm	390mm	380mm	340mm
PAN WIDTH	455mm	370mm	235mm	225mm	185mm

Add 5mm to above pan size for effective cover.

DETAIL ANNOTATION:

1. PANEL WIDTHS ARE GENERALLY DETERMINED BY COIL SIZE AVAILABILITY.
2. FOR SIZES OUTSIDE THESE NORMAL COIL WIDTHS PLEASE CONTACT ROOFING INDUSTRIES.
3. ROOFING INDUSTRIES 'EUROSTYLE SPANLOK' CAN BE INSTALLED WITHOUT A PLY SUBSTRATE. REFER TO ROOFING INDUSTRIES PRODUCT TECHNICAL STATEMENT AND INSTALLATION GUIDE.

GENERAL NOTES:

- These details are to be read with Roofing Industries SPANLOK™ Product Technical Statement and installation guide.
- These details are generally in compliance with E2/AS1 and/or the NZ Metal Roof & Wall Cladding Code of Practice and in some cases specific details by 'Roofing Industries'.
- The building designer is ultimately responsible to ensure that details used meet the requirements of the NZ Building Code for the specific project.
- Details of the supporting structure including cavity battens are indicative only and are the responsibility of the building designer. For steel framed buildings thermal break cavity battens may be required.
- Roof/wall underlay selection are the responsibility of the designer. Underlay to be installed in accordance with underlay manufacturer's recommendations and requirements.
- These details are for Roofing Industries profile/s as nominated and may not be applicable to other profiles.
- This drawing is the copyright of 'Roofing Industries' and can only be copied or reproduced with their permission.
- Further information can be obtained from the NZ Metal Roof & Wall Cladding Code of Practice: www.metalroofing.org.nz or E2/AS1.
- Details are for steel based materials, other substrates may require some changes.
- All dimensions are nominal.

Copyright detail © 2024



EUROSTYLE SPANLOK™ VARIABLE PAN ROOFING ON PURLINS ROLL CAP

Detail Number: RI-ESVPRRPUR-000D

Date drawn: 20/05/2024

Scale: As indicated@ A4

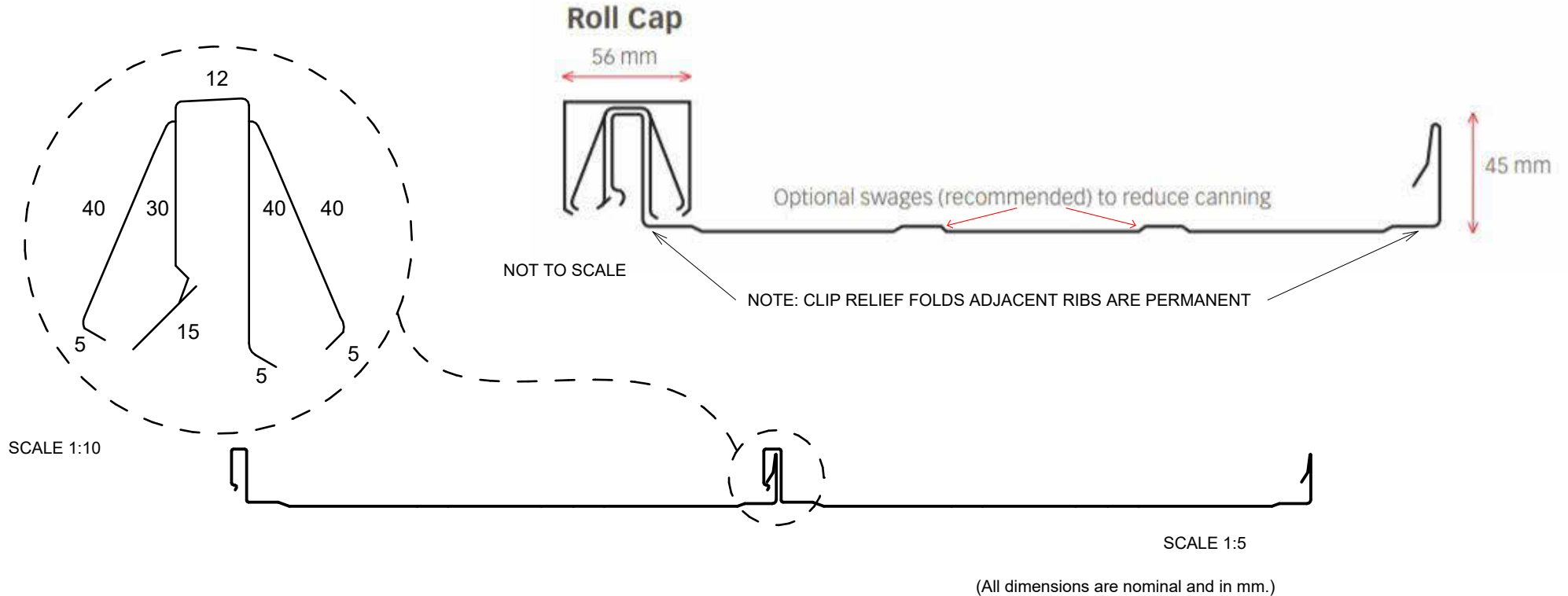

GENERAL NOTES:

- These details are to be read with Roofing Industries SPANLOK™ Product Technical Statement and installation guide.
- These details are generally in compliance with E2/AS1 and/or the NZ Metal Roof & Wall Cladding Code of Practice and in some cases specific details by 'Roofing Industries'.
- The building designer is ultimately responsible to ensure that details used meet the requirements of the NZ Building Code for the specific project.
- Details of the supporting structure including cavity battens are indicative only and are the responsibility of the building designer. For steel framed buildings thermal break cavity battens may be required.
- Roof/wall underlay selection are the responsibility of the designer. Underlay to be installed in accordance with underlay manufacturer's recommendations and requirements.
- These details are for Roofing Industries profile/s as nominated and may not be applicable to other profiles.
- This drawing is the copyright of 'Roofing Industries' and can only be copied or reproduced with their permission.
- Further information can be obtained from the NZ Metal Roof & Wall Cladding Code of Practice: www.metalroofing.org.nz or E2/AS1.
- Details are for steel based materials, other substrates may require some changes.
- All dimensions are nominal.

Copyright detail © 2024



EUROSTYLE SPANLOK™ VARIABLE PAN ROOFING ON PURLINS BARGE DETAIL (TYPE 1)

Detail Number: RI-ESVPRRPUR-030A

Date drawn: 20/05/2024

Scale: 1 : 5@ A4

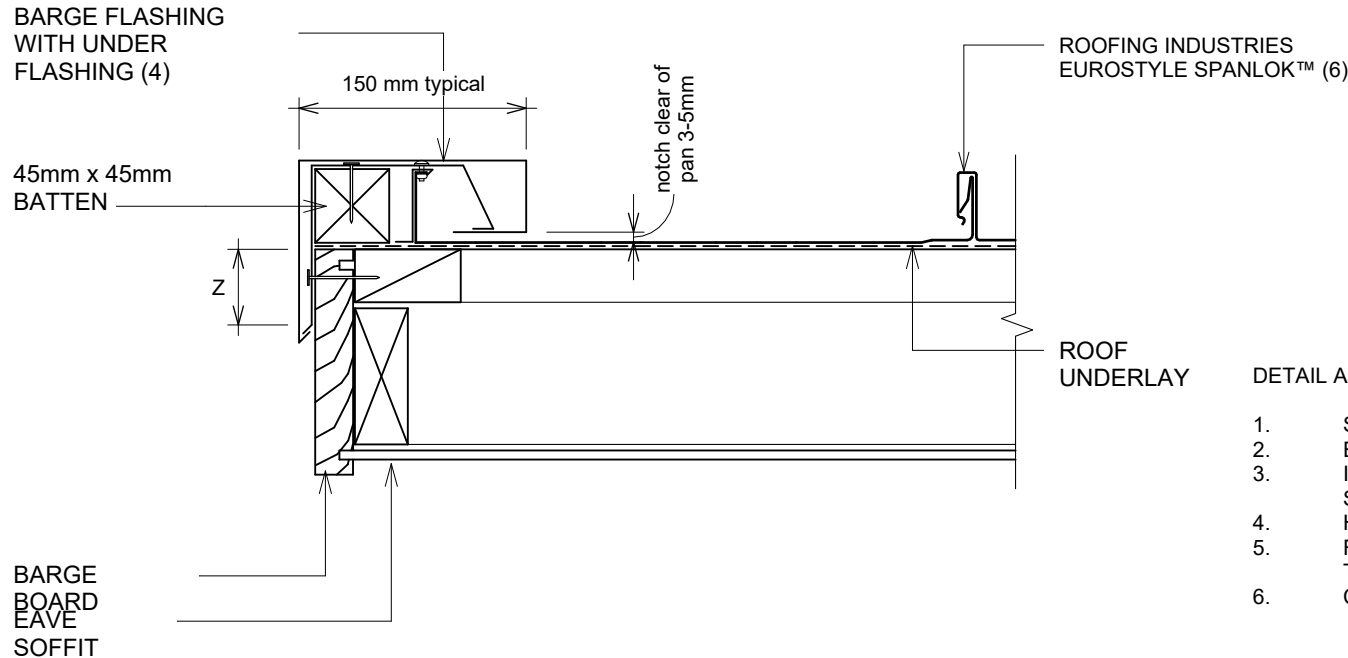

SITE WIND ZONE (As per NZS3604)	MINIMUM
	Z (2)
SITUATION 1	50mm
SITUATION 2	75mm
SITUATION 3	90mm

DETAIL ANNOTATION:

1. SITUATION 1, 2 & 3 AS PER E2/AS1 TABLE 7
2. EXCLUDING DRIP EDGE
3. INCREASE DISTANCE 'Z' BY 25mm WHEN AGAINST A PROFILED SURFACE OR TO 100mm WHICHEVER IS THE LESSER.
4. HIGH TO EXTRA HIGH WIND ZONE DOUBLE FIX UNDERFLASHINGS
5. FASTENERS TO BE COMPATIBLE WITH MATERIAL BEING FIXED AND THE SUITABLE GRADE FOR THE ENVIRONMENT IN WHICH LOCATED
6. CLIPS OMITTED FOR CLARITY

GENERAL NOTES:

- These details are to be read with Roofing Industries SPANLOK™ Product Technical Statement and installation guide.
- These details are generally in compliance with E2/AS1 and/or the NZ Metal Roof & Wall Cladding Code of Practice and in some cases specific details by 'Roofing Industries'.
- The building designer is ultimately responsible to ensure that details used meet the requirements of the NZ Building Code for the specific project.
- Details of the supporting structure including cavity battens are indicative only and are the responsibility of the building designer. For steel framed buildings thermal break cavity battens may be required.
- Roof/wall underlay selection are the responsibility of the designer. Underlay to be installed in accordance with underlay manufacturer's recommendations and requirements.
- These details are for Roofing Industries profile/s as nominated and may not be applicable to other profiles.
- This drawing is the copyright of 'Roofing Industries' and can only be copied or reproduced with their permission.
- Further information can be obtained from the NZ Metal Roof & Wall Cladding Code of Practice: www.metalroofing.org.nz or E2/AS1.
- Details are for steel based materials, other substrates may require some changes.
- All dimensions are nominal.



interactive assembly instructions available

Copyright detail © 2024

<http://wksp.nz/ri-esl-bar>



Get WORKINGSPEC from Apple App Store/Google Play



EUROSTYLE SPANLOK™ VARIABLE PAN ROOFING ON PURLINS BARGE DETAIL (TYPE 2)

Detail Number: RI-ESVPRRPUR-030B

Date drawn: 20/05/2024

Scale: 1 : 5@ A4

DRY PAN BARGE
FLASHING WITH
UNDER FLASHING (4)

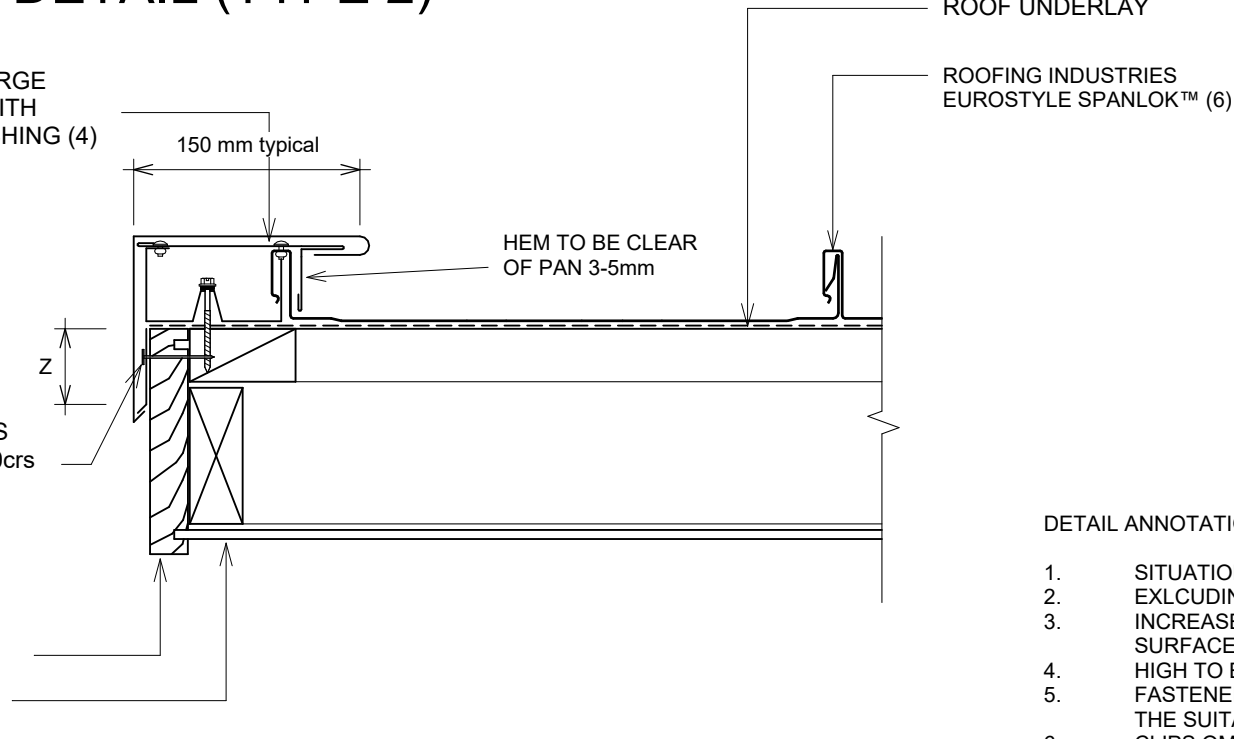

SITE WIND ZONE (As per NZS3604)	MINIMUM Z (2)
SITUATION 1	50mm
SITUATION 2	75mm
SITUATION 3	90mm

DETAIL ANNOTATION:

1. SITUATION 1, 2 & 3 AS PER E2/AS1 TABLE 7
2. EXCLUDING DRIP EDGE
3. INCREASE DISTANCE 'Z' BY 25mm WHEN AGAINST A PROFILED SURFACE OR TO 100mm WHICHEVER IS THE LESSER.
4. HIGH TO EXTRA HIGH WIND ZONE DOUBLE FIX UNDERFLASHINGS
5. FASTENERS TO BE COMPATIBLE WITH MATERIAL BEING FIXED AND THE SUITABLE GRADE FOR THE ENVIRONMENT IN WHICH LOCATED
6. CLIPS OMITTED FOR CLARITY

GENERAL NOTES:

- These details are to be read with Roofing Industries SPANLOK™ Product Technical Statement and installation guide.
- These details are generally in compliance with E2/AS1 and/or the NZ Metal Roof & Wall Cladding Code of Practice and in some cases specific details by 'Roofing Industries'.
- The building designer is ultimately responsible to ensure that details used meet the requirements of the NZ Building Code for the specific project.
- Details of the supporting structure including cavity battens are indicative only and are the responsibility of the building designer. For steel framed buildings thermal break cavity battens may be required.
- Roof/wall underlay selection are the responsibility of the designer. Underlay to be installed in accordance with underlay manufacturer's recommendations and requirements.
- These details are for Roofing Industries profile/s as nominated and may not be applicable to other profiles.
- This drawing is the copyright of 'Roofing Industries' and can only be copied or reproduced with their permission.
- Further information can be obtained from the NZ Metal Roof & Wall Cladding Code of Practice: www.metalroofing.org.nz or E2/AS1.
- Details are for steel based materials, other substrates may require some changes.
- All dimensions are nominal.



Copyright detail © 2024

<http://wksp.nz/ri-esl-bar>



Get WORKINGSPEC from
Apple App Store/Google Play



EUROSTYLE SPANLOK™ VARIABLE PAN ROOFING ON PURLINS BARGE DETAIL (TYPE 3)

Detail Number: RI-ESVPRRPUR-030C

Date drawn: 20/05/2024

Scale: 1 : 5@ A4

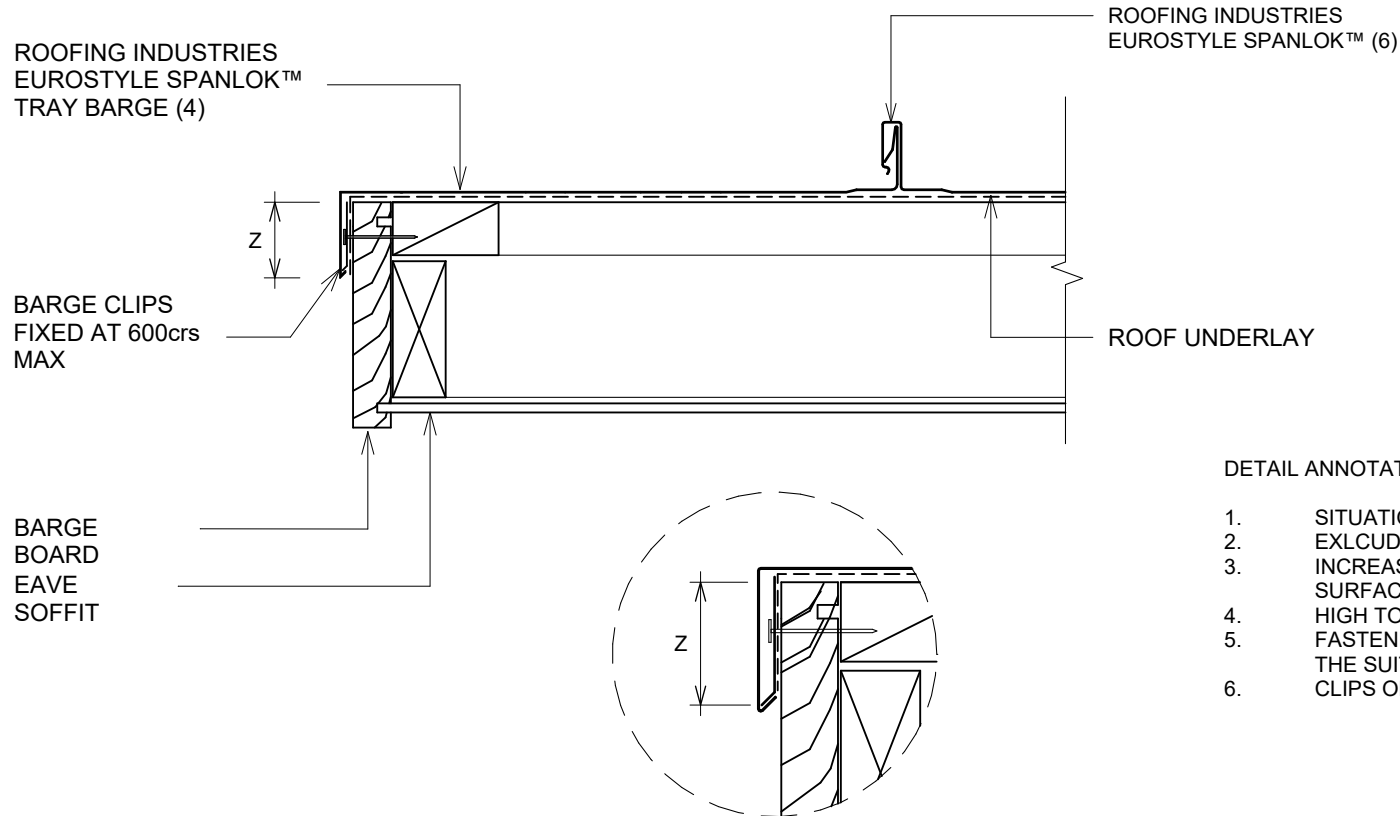

SITE WIND ZONE (As per NZS3604)	MINIMUM
	Z (2)
SITUATION 1	50mm
SITUATION 2	75mm
SITUATION 3	90mm

DETAIL ANNOTATION:

1. SITUATION 1, 2 & 3 AS PER E2/AS1 TABLE 7
2. EXCLUDING DRIP EDGE
3. INCREASE DISTANCE 'Z' BY 25mm WHEN AGAINST A PROFILED SURFACE OR TO 100mm WHICHEVER IS THE LESSER.
4. HIGH TO EXTRA HIGH WIND ZONE DOUBLE FIX UNDERFLASHINGS
5. FASTENERS TO BE COMPATIBLE WITH MATERIAL BEING FIXED AND THE SUITABLE GRADE FOR THE ENVIRONMENT IN WHICH LOCATED
6. CLIPS OMITTED FOR CLARITY

GENERAL NOTES:

- These details are to be read with Roofing Industries SPANLOK™ Product Technical Statement and installation guide.
- These details are generally in compliance with E2/AS1 and/or the NZ Metal Roof & Wall Cladding Code of Practice and in some cases specific details by 'Roofing Industries'.
- The building designer is ultimately responsible to ensure that details used meet the requirements of the NZ Building Code for the specific project.
- Details of the supporting structure including cavity battens are indicative only and are the responsibility of the building designer. For steel framed buildings thermal break cavity battens may be required.
- Roof/wall underlay selection are the responsibility of the designer. Underlay to be installed in accordance with underlay manufacturer's recommendations and requirements.
- These details are for Roofing Industries profile/s as nominated and may not be applicable to other profiles.
- This drawing is the copyright of 'Roofing Industries' and can only be copied or reproduced with their permission.
- Further information can be obtained from the NZ Metal Roof & Wall Cladding Code of Practice: www.metalroofing.org.nz or E2/AS1.
- Details are for steel based materials, other substrates may require some changes.
- All dimensions are nominal.



interactive assembly
instructions available

Copyright detail © 2024

<http://wksp.nz/ri-esl-bar>



Get **WORKINGSPEC** from
Apple App Store/Google Play



EUROSTYLE SPANLOK™ VARIABLE PAN ROOFING ON PURLINS TYPICAL HEAD BARGE DETAIL

Detail Number: RI-ESVPRRPUR-040

Date drawn: 20/05/2024

Scale: 1 : 5@ A4

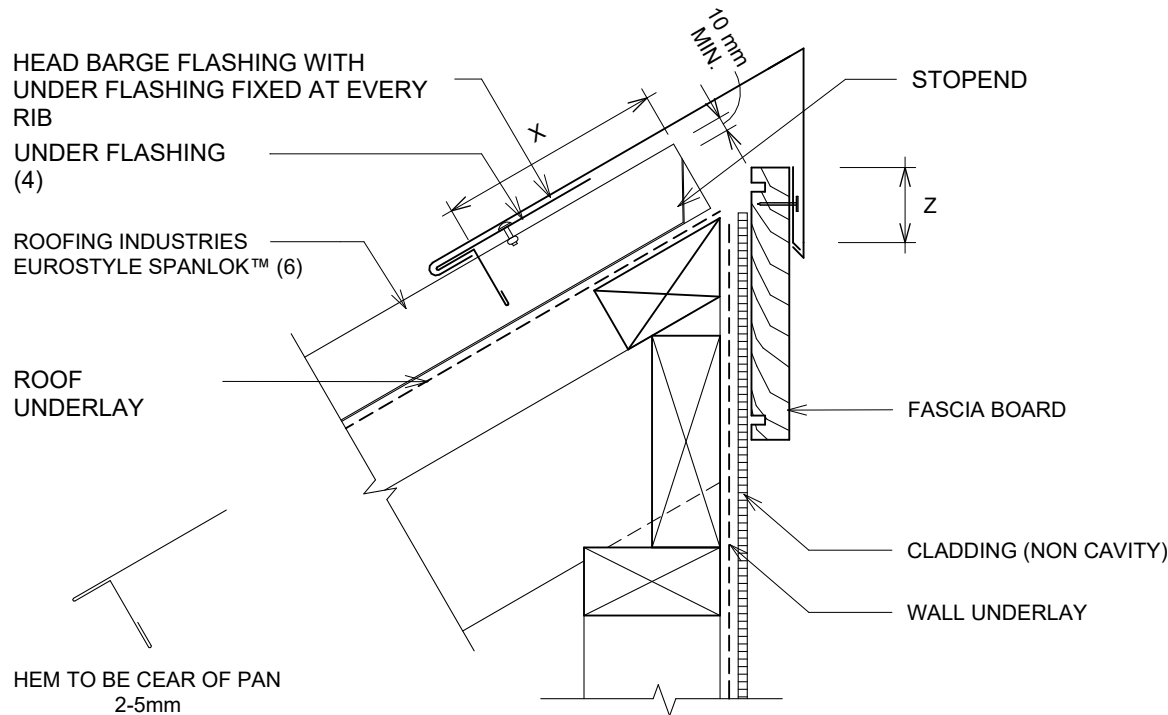

SITE WIND ZONE (As per NZS3604)	MINIMUM	
	Z (2)	X
SITUATION 1	50mm	150mm
SITUATION 2	75mm	200mm
SITUATION 3	90mm	200mm

DETAIL ANNOTATION:

1. SITUATION 1, 2 & 3 AS PER E2/AS1 TABLE 7 EXCLUDING DRIP EDGE
2. INCREASE DISTANCE 'Z' BY 25mm WHEN AGAINST A PROFILED SURFACE OR TO 100mm WHICHEVER IS THE LESSER.
3. HIGH TO EXTRA HIGH WIND ZONE DOUBLE FIX UNDERFLASHINGS
4. FASTENERS TO BE COMPATIBLE WITH MATERIAL BEING FIXED AND THE SUITABLE GRADE FOR THE ENVIRONMENT IN WHICH LOCATED
5. CLIPS OMITTED FOR CLARITY

GENERAL NOTES:

- These details are to be read with Roofing Industries SPANLOK™ Product Technical Statement and installation guide.
- These details are generally in compliance with E2/AS1 and/or the NZ Metal Roof & Wall Cladding Code of Practice and in some cases specific details by 'Roofing Industries'.
- The building designer is ultimately responsible to ensure that details used meet the requirements of the NZ Building Code for the specific project.
- Details of the supporting structure including cavity battens are indicative only and are the responsibility of the building designer. For steel framed buildings thermal break cavity battens may be required.
- Roof/wall underlay selection are the responsibility of the designer. Underlay to be installed in accordance with underlay manufacturer's recommendations and requirements.
- These details are for Roofing Industries profile/s as nominated and may not be applicable to other profiles.
- This drawing is the copyright of 'Roofing Industries' and can only be copied or reproduced with their permission.
- Further information can be obtained from the NZ Metal Roof & Wall Cladding Code of Practice: www.metalroofing.org.nz or E2/AS1.
- Details are for steel based materials, other substrates may require some changes.
- All dimensions are nominal.



Copyright detail © 2024

<http://wksp.nz/ri-esl-bar>



Get WORKINGSPEC from
Apple App Store/Google Play



EUROSTYLE SPANLOK™ VARIABLE PAN ROOFING ON PURLINS TYPICAL CHANGE IN PITCH

Detail Number: RI-ESVPRRPUR-050

Date drawn: 20/05/2024

Scale: 1 : 5@ A4

STOPEND TO PROFILE

CHANGE IN PITCH FLASHING
WITH UNDER FLASHING FIXED TO
SUPPORTING PURLINS TO EVERY
RIB

UNDERFLASHING (2)

ROOFING INDUSTRIES
EUROSTYLE SPANLOK™ (5)

ROOF UNDERLAY

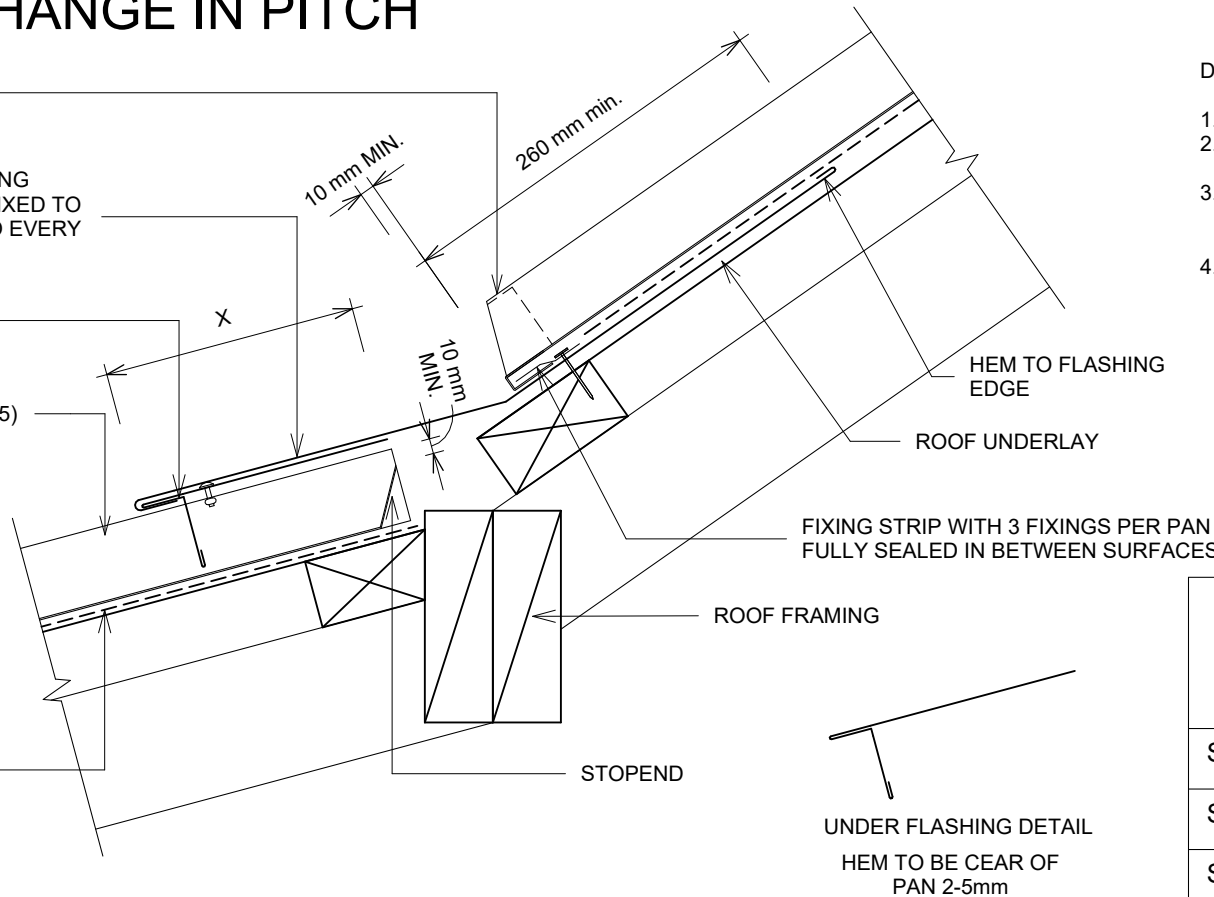

DETAIL ANNOTATION:

1. SITUATION 1, 2 & 3 AS PER E2/AS1 TABLE 7
2. HIGH TO EXTRA HIGH WIND ZONE DOUBLE FIX UNDERFLASHINGS
3. FASTENERS TO BE COMPATIBLE WITH MATERIAL BEING FIXED AND THE SUITABLE GRADE FOR THE ENVIRONMENT IN WHICH LOCATED
4. CLIPS OMITTED FOR CLARITY

SITE WIND ZONE (As per NZS3604)	X	MINIMUM
	TRANSVERSE FLASHING OVER ROOFING	UPPER LAP UNDER ROOFING
SITUATION 1	130mm	250mm
SITUATION 2	200mm	250mm
SITUATION 3	(3)	

GENERAL NOTES:

- These details are to be read with Roofing Industries SPANLOK™ Product Technical Statement and installation guide.
- These details are generally in compliance with E2/AS1 and/or the NZ Metal Roof & Wall Cladding Code of Practice and in some cases specific details by 'Roofing Industries'.
- The building designer is ultimately responsible to ensure that details used meet the requirements of the NZ Building Code for the specific project.
- Details of the supporting structure including cavity battens are indicative only and are the responsibility of the building designer. For steel framed buildings thermal break cavity battens may be required.
- Roof/wall underlay selection are the responsibility of the designer. Underlay to be installed in accordance with underlay manufacturer's recommendations and requirements.
- These details are for Roofing Industries profile/s as nominated and may not be applicable to other profiles.
- This drawing is the copyright of 'Roofing Industries' and can only be copied or reproduced with their permission.
- Further information can be obtained from the NZ Metal Roof & Wall Cladding Code of Practice: www.metalroofing.org.nz or E2/AS1.
- Details are for steel based materials, other substrates may require some changes.
- All dimensions are nominal.



interactive assembly
instructions available

Copyright detail © 2024

<http://wksp.nz/ri-esl-bar>



Get WORKINGSPEC from
Apple App Store/Google Play



EUROSTYLE SPANLOK™ VARIABLE PAN ROOFING ON PURLINS MANSARD / EXTERNAL CHANGE IN PITCH FLASHING

Detail Number: RI-ESVPRRPUR-050B

Date drawn: 20/05/2024

Scale: 1 : 5@ A4

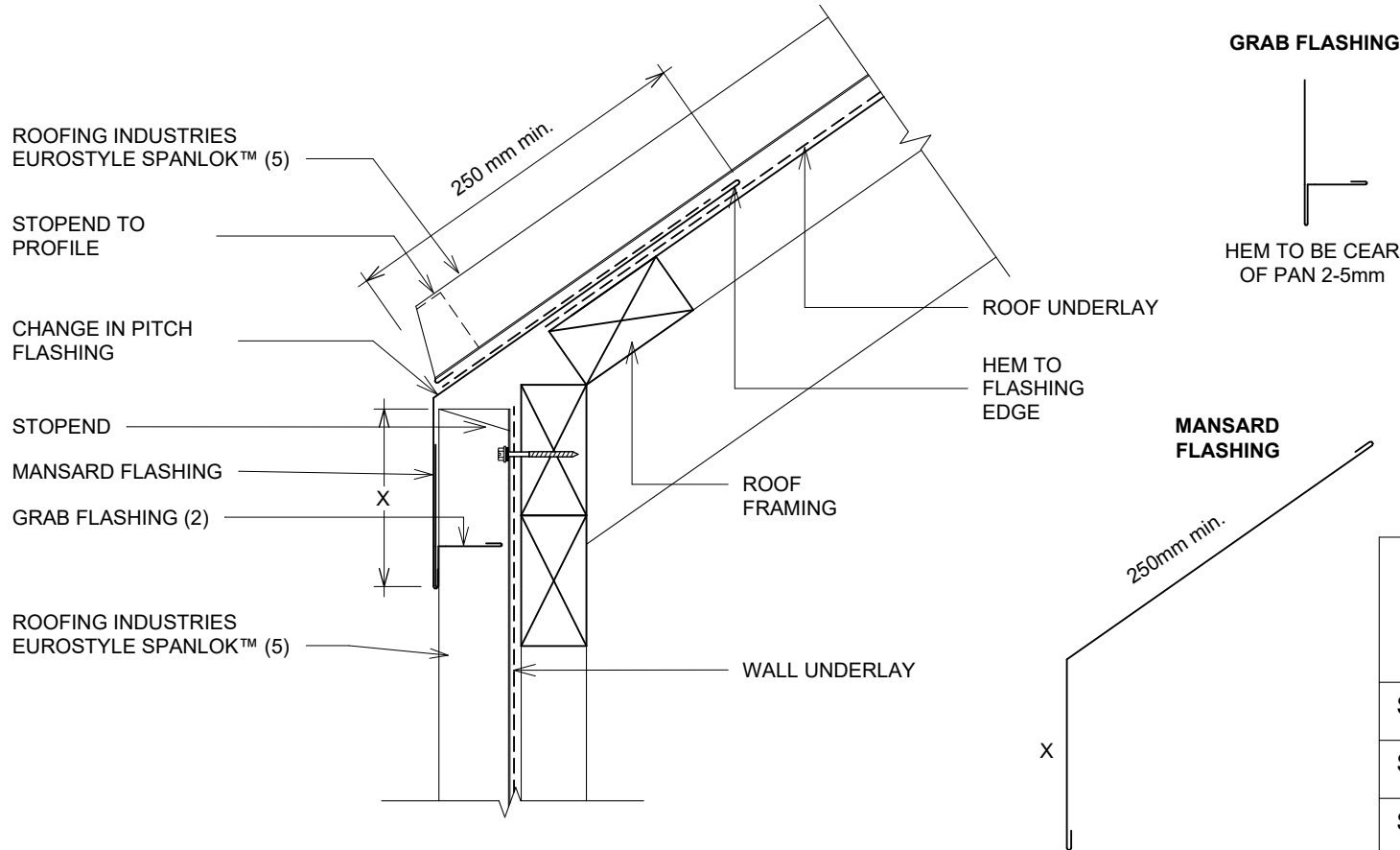

DETAIL ANNOTATION:

1. SITUATION 1, 2 & 3 AS PER E2/AS1 TABLE 7
2. HIGH TO EXTRA HIGH WIND ZONE DOUBLE FIX UNDERFLASHINGS
3. FASTENERS TO BE COMPATIBLE WITH MATERIAL BEING FIXED AND THE SUITABLE GRADE FOR THE ENVIRONMENT IN WHICH LOCATED
4. CLIPS OMITTED FOR CLARITY

SITE WIND ZONE (As per NZS3604)	X	MINIMUM
	TRANSVERSE FLASHING OVER ROOFING	UPPER LAP UNDER ROOFING
SITUATION 1	130mm	250mm
SITUATION 2	200mm	250mm
SITUATION 3	(3)	

GENERAL NOTES:

- These details are to be read with Roofing Industries SPANLOK™ Product Technical Statement and installation guide.
- These details are generally in compliance with E2/AS1 and/or the NZ Metal Roof & Wall Cladding Code of Practice and in some cases specific details by 'Roofing Industries'.
- The building designer is ultimately responsible to ensure that details used meet the requirements of the NZ Building Code for the specific project.
- Details of the supporting structure including cavity battens are indicative only and are the responsibility of the building designer. For steel framed buildings thermal break cavity battens may be required.
- Roof/wall underlay selection are the responsibility of the designer. Underlay to be installed in accordance with underlay manufacturer's recommendations and requirements.
- These details are for Roofing Industries profile/s as nominated and may not be applicable to other profiles.
- This drawing is the copyright of 'Roofing Industries' and can only be copied or reproduced with their permission.
- Further information can be obtained from the NZ Metal Roof & Wall Cladding Code of Practice: www.metalroofing.org.nz or E2/AS1.
- Details are for steel based materials, other substrates may require some changes.
- All dimensions are nominal.

Copyright detail © 2024



EUROSTYLE SPANLOK™ VARIABLE PAN ROOFING ON PURLINS GUTTER APRON DETAIL

Detail Number: RI-ESVPRRPUR-060A

Date drawn: 20/05/2024

Scale: 1 : 5@ A4

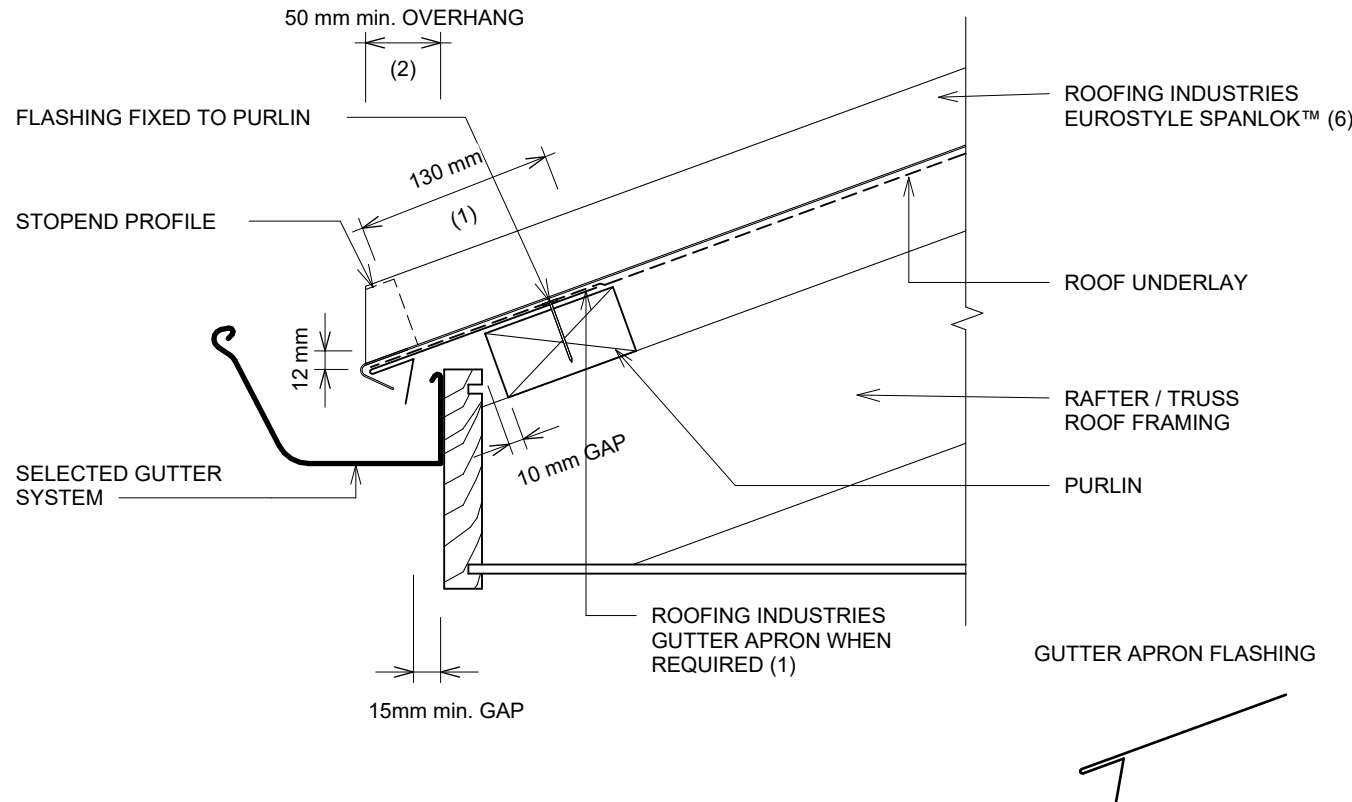

DETAIL ANNOTATION:

1. WHERE THE EAVE FLASHING IS REQUIRED, DESIGNER MAY ALSO CHOOSE TO INCLUDE OPTIONALLY. ALSO RECOMMENDED IN VERY CORROSIVE ENVIRONMENTS AND WHEN SPOUTING IS LOW OR WHERE A GAP EXISTS BETWEEN THE BACK OF GUTTER AND THE FASCIA BOARD.
2. OVERHANG TO GUTTER WHERE THE PITCH IS BELOW 10° AND THE ENDS OF THE RIBS ARE NOT BAFFLED BY THE SPOUTING, SHALL BE INCREASED TO 70mm. REFER TO MRM COP.
3. FASTENERS TO BE COMPATIBLE WITH MATERIAL BEING FIXED AND THE SUITABLE GRADE FOR THE ENVIRONMENT IN WHICH LOCATED.
4. RI RECOMMENDS AN EAVE FLASHING FOR ALL PITCHES BELOW 10°
5. HIGH TO EXTRA HIGH WIND ZONE DOUBLE FIX UNDERFLASHINGS.
6. CLIPS OMITTED FOR CLARITY

GENERAL NOTES:

- These details are to be read with Roofing Industries SPANLOK™ Product Technical Statement and installation guide.
- These details are generally in compliance with E2/AS1 and/or the NZ Metal Roof & Wall Cladding Code of Practice and in some cases specific details by 'Roofing Industries'.
- The building designer is ultimately responsible to ensure that details used meet the requirements of the NZ Building Code for the specific project.
- Details of the supporting structure including cavity battens are indicative only and are the responsibility of the building designer. For steel framed buildings thermal break cavity battens may be required.
- Roof/wall underlay selection are the responsibility of the designer. Underlay to be installed in accordance with underlay manufacturer's recommendations and requirements.
- These details are for Roofing Industries profile/s as nominated and may not be applicable to other profiles.
- This drawing is the copyright of 'Roofing Industries' and can only be copied or reproduced with their permission.
- Further information can be obtained from the NZ Metal Roof & Wall Cladding Code of Practice: www.metalroofing.org.nz or E2/AS1.
- Details are for steel based materials, other substrates may require some changes.
- All dimensions are nominal.



interactive assembly
instructions available

Copyright detail © 2024

<http://wksp.nz/ri-esl-bar>



Get WORKINGSPEC from
Apple App Store/Google Play



EUROSTYLE SPANLOK™ VARIABLE PAN ROOFING ON PURLINS GUTTER APRON DETAIL (NO SOFFIT)

Detail Number: RI-ESVPRRPUR-060C

Date drawn: 20/05/2024

Scale: 1 : 5@ A4

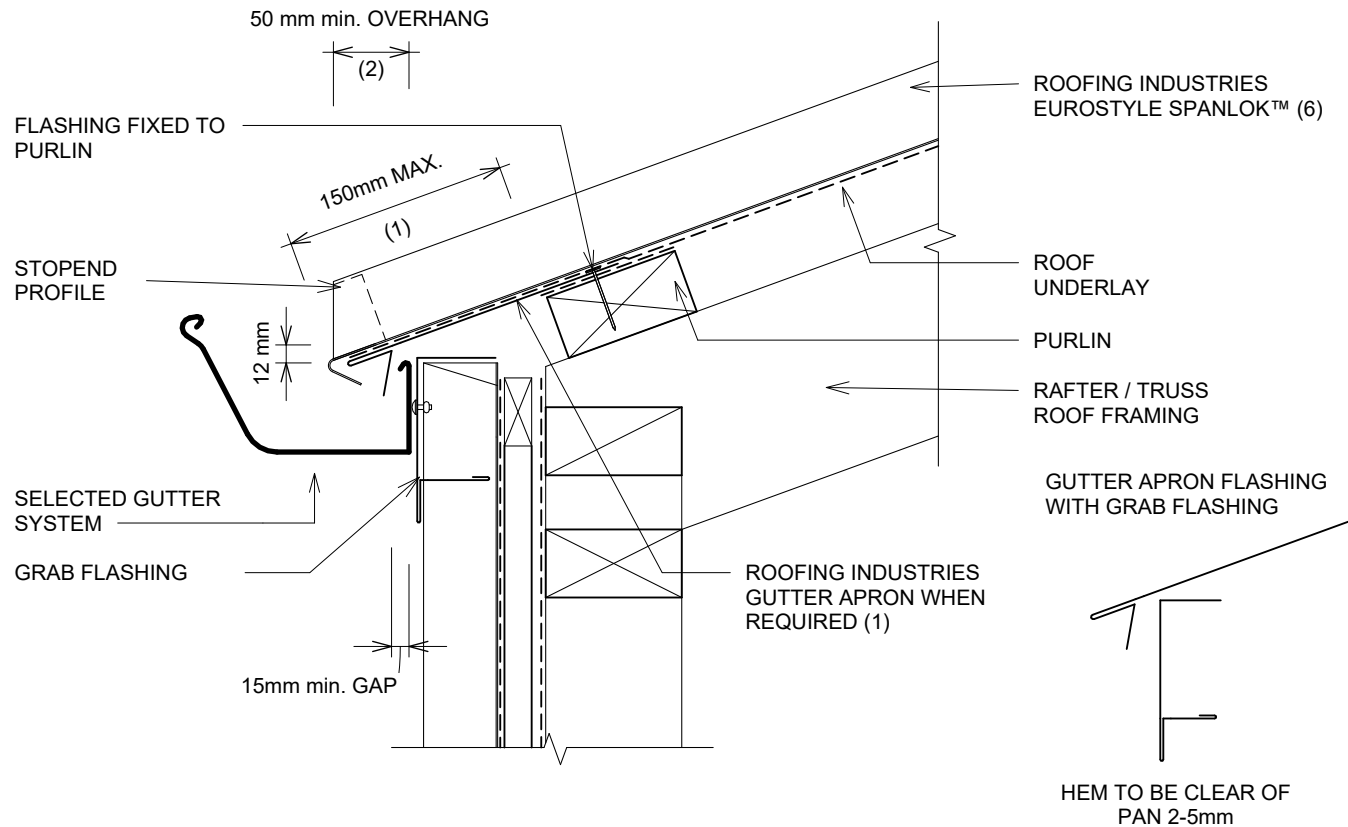

DETAIL ANNOTATION:

1. WHERE THE EAVE FLASHING IS REQUIRED. DESIGNER MAY ALSO CHOOSE TO INCLUDE OPTIONALLY. ALSO RECOMMENDED IN VERY CORROSIVE ENVIRONMENTS AND WHEN SPOUTING IS LOW OR WHERE A GAP EXISTS BETWEEN THE BACK OF GUTTER AND THE FASCIA BOARD.
2. OVERHANG TO GUTTER WHERE THE PITCH IS BELOW 10° AND THE ENDS OF THE RIBS ARE NOT BAFFLED BY THE SPOUTING, SHALL BE INCREASED TO 70mm. REFER TO MRM COP.
3. FASTENERS TO BE COMPATIBLE WITH MATERIAL BEING FIXED AND THE SUITABLE GRADE FOR THE ENVIRONMENT IN WHICH LOCATED.
4. RI RECOMMENDS AN EAVE FLASHING FOR ALL PITCHES BELOW 10°
5. HIGH TO EXTRA HIGH WIND ZONE DOUBLE FIX UNDERFLASHINGS.
6. CLIPS OMITTED FOR CLARITY

GENERAL NOTES:

- These details are to be read with Roofing Industries SPANLOK™ Product Technical Statement and installation guide.
- These details are generally in compliance with E2/AS1 and/or the NZ Metal Roof & Wall Cladding Code of Practice and in some cases specific details by 'Roofing Industries'.
- The building designer is ultimately responsible to ensure that details used meet the requirements of the NZ Building Code for the specific project.
- Details of the supporting structure including cavity battens are indicative only and are the responsibility of the building designer. For steel framed buildings thermal break cavity battens may be required.
- Roof/wall underlay selection are the responsibility of the designer. Underlay to be installed in accordance with underlay manufacturer's recommendations and requirements.
- These details are for Roofing Industries profile/s as nominated and may not be applicable to other profiles.
- This drawing is the copyright of 'Roofing Industries' and can only be copied or reproduced with their permission.
- Further information can be obtained from the NZ Metal Roof & Wall Cladding Code of Practice: www.metalroofing.org.nz or E2/AS1.
- Details are for steel based materials, other substrates may require some changes.
- All dimensions are nominal.

Copyright detail © 2024



EUROSTYLE SPANLOK™ VARIABLE PAN ROOFING ON PURLINS VENTILATED RIDGE AND HIP DETAIL

Detail Number: RI-ESVPRRPUR-070A

Date drawn: 20/05/2024

Scale: 1 : 5@ A4

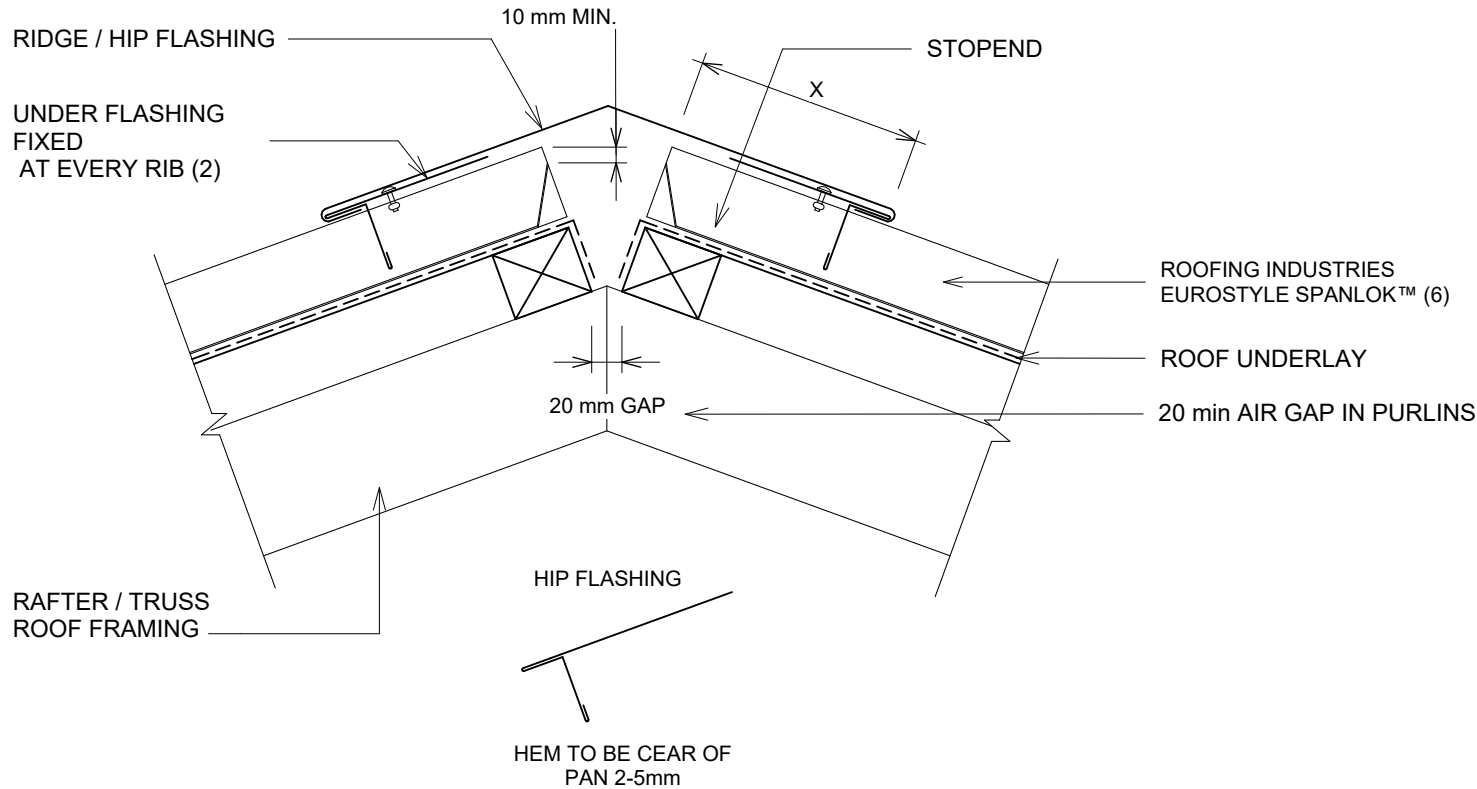

DETAIL ANNOTATION:

1. FASTENERS TO BE COMPATIBLE WITH MATERIAL BEING FIXED AND THE SUITABLE GRADE FOR THE ENVIRONMENT IN WHICH LOCATED.
2. HIGH TO EXTRA HIGH WIND ZONE DOUBLE FIX UNDERFLASHINGS.
3. CLIPS OMITTED FOR CLARITY

WIND ZONE	MINIMUM
	X
SITUATION 1	150mm
SITUATION 2 & 3	200mm

GENERAL NOTES:

- These details are to be read with Roofing Industries SPANLOK™ Product Technical Statement and installation guide.
- These details are generally in compliance with E2/AS1 and/or the NZ Metal Roof & Wall Cladding Code of Practice and in some cases specific details by 'Roofing Industries'.
- The building designer is ultimately responsible to ensure that details used meet the requirements of the NZ Building Code for the specific project.
- Details of the supporting structure including cavity battens are indicative only and are the responsibility of the building designer. For steel framed buildings thermal break cavity battens may be required.
- Roof/wall underlay selection are the responsibility of the designer. Underlay to be installed in accordance with underlay manufacturer's recommendations and requirements.
- These details are for Roofing Industries profile/s as nominated and may not be applicable to other profiles.
- This drawing is the copyright of 'Roofing Industries' and can only be copied or reproduced with their permission.
- Further information can be obtained from the NZ Metal Roof & Wall Cladding Code of Practice: www.metalroofing.org.nz or E2/AS1.
- Details are for steel based materials, other substrates may require some changes.
- All dimensions are nominal.

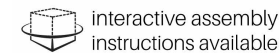

interactive assembly
instructions available

Copyright detail © 2024

<http://wksp.nz/ri-esl-bar>



Get WORKINGSPEC from
Apple App Store/Google Play



EUROSTYLE SPANLOK™ VARIABLE PAN ROOFING ON PURLINS BARGE & RIDGE UNDER FLASHINGS

Detail Number: RI-ESVPRRPUR-070B

Date drawn: 20/05/2024

Scale: 1 : 5@ A4

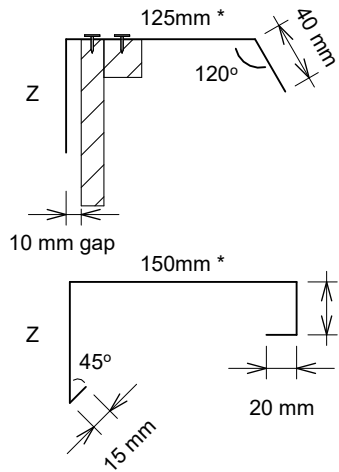

SITE WIND ZONE (As per NZS3604)	MINIMUM
	Z
SITUATION 1	50mm
SITUATION 2	75mm
SITUATION 3	90mm

NOTE:

- 300mm LONG EVERY 600mm APPROX
- * DEDUCT 25mm FOR UNDERFLASHING

RIDGE UNDERFLASHING:

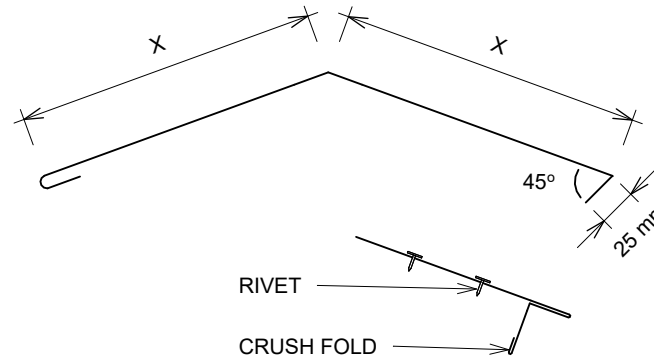

SITE WIND ZONE (As per NZS3604)	MINIMUM
	X
SITUATION 1	150mm
SITUATION 2	200mm
SITUATION 3	200mm

NOTE:

SET UNDERFLASHING 5mm BACK FROM RIDGE
MEASUREMENT EACH SIDE 190mm

DETAIL ANNOTATION:

- SITUATION 1, 2 & 3 AS PER E2/AS1, TABLE 7
- INCREASE DISTANCE 'Z' BY 25mm WHEN AGAINST A PROFILED SURFACE OR TO 100mm WHICHEVER IS THE LESSER.
- HIGH TO EXTRA HIGH WIND ZONE DOUBLE FIX UNDERFLASHINGS
- ALLOW FOR SEPARATION FROM ANY CORROSIVE TIMBER TREATMENTS.

DETAIL ANNOTATION:

- SITUATION 1, 2 & 3 AS PER E2/AS1 TABLE 7
- FOR GRAVITY RIDGE VENT TO FUNCTION, ADDITIONAL VENTILATION IS REQUIRED AT THE EAVE.
- ALLOW FOR SEPARATION FROM ANY CORROSIVE TIMBER TREATMENTS.
- HIGH TO EXTRA HIGH WIND ZONE DOUBLE FIX UNDERFLASHINGS.
- EUROSTYLE CLIP TO TOP PURLIN.
- ALL DIMENSIONS SHOWN ON DRAWINGS ARE NOMINAL +/- 5mm
- STOPEND 5-10mm FROM TOP OF RIB TO ACHIEVE VENTILATION IF REQUIRED

GENERAL NOTES:

- These details are to be read with Roofing Industries SPANLOK™ Product Technical Statement and installation guide.
- These details are generally in compliance with E2/AS1 and/or the NZ Metal Roof & Wall Cladding Code of Practice and in some cases specific details by 'Roofing Industries'.
- The building designer is ultimately responsible to ensure that details used meet the requirements of the NZ Building Code for the specific project.
- Details of the supporting structure including cavity battens are indicative only and are the responsibility of the building designer. For steel framed buildings thermal break cavity battens may be required.
- Roof/wall underlay selection are the responsibility of the designer. Underlay to be installed in accordance with underlay manufacturer's recommendations and requirements.
- These details are for Roofing Industries profile/s as nominated and may not be applicable to other profiles.
- This drawing is the copyright of 'Roofing Industries' and can only be copied or reproduced with their permission.
- Further information can be obtained from the NZ Metal Roof & Wall Cladding Code of Practice: www.metalroofing.org.nz or E2/AS1.
- Details are for steel based materials, other substrates may require some changes.
- All dimensions are nominal.

Copyright detail © 2024



EUROSTYLE SPANLOK™ VARIABLE PAN ROOFING ON PURLINS TYPICAL VALLEY DETAIL

Detail Number: RI-ESVPRRPUR-080A

Date drawn: 20/05/2024

Scale: 1 : 5@ A4

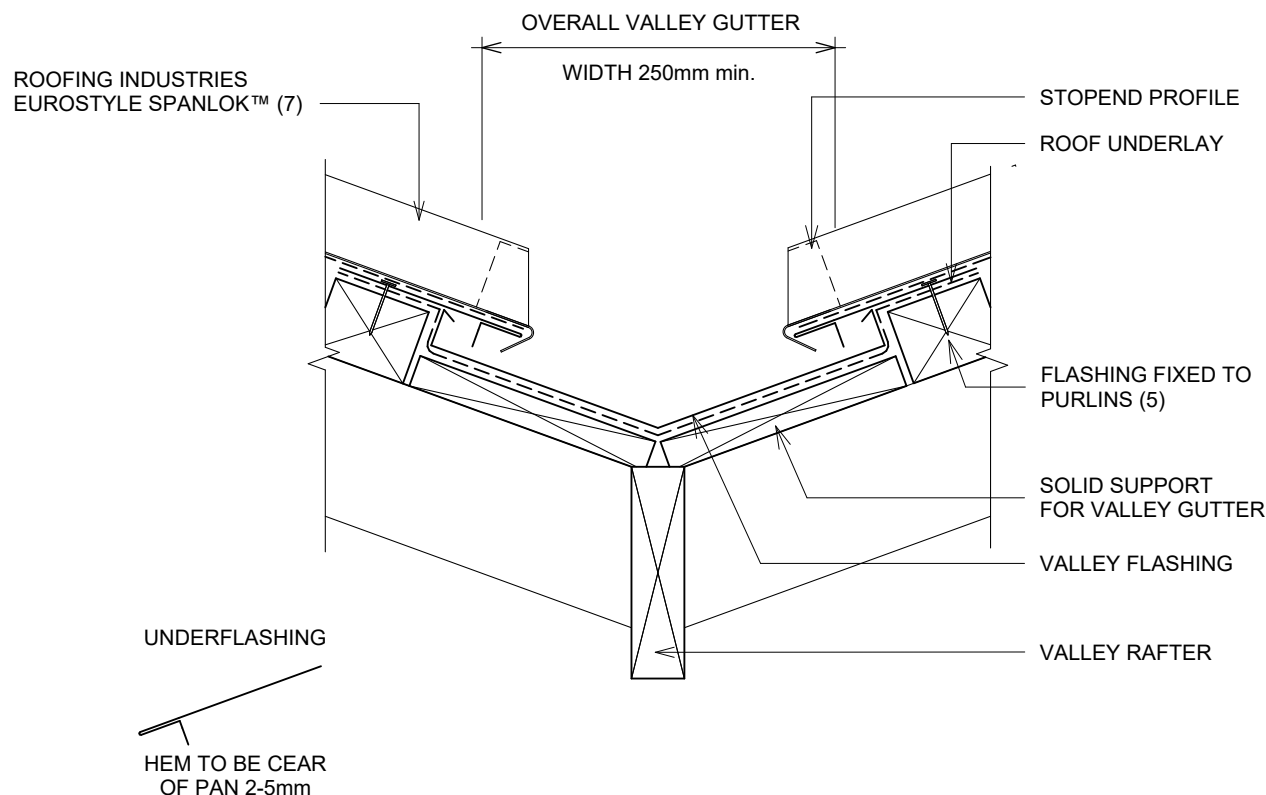

DETAIL ANNOTATION:

1. GUTTERS IN ACCORDANCE WITH NEW ZEALAND BUILDING CODE E2/AS1
2. RAINFALL INTENSITY WITH AVERAGE RECURRENCE INTERVAL (ARI) NO GREATER THAN 200mm PER HOUR
3. MINIMUM WIDTH OF VALLEY GUTTER MAY REDUCE TO 160mm, PROVIDING ROOF CATCHMENT AREA IS IN ACCORDANCE WITH THE TABLE ABOVE. IN THIS CASE, COVER OF ROOF CLADDING OVER GUTTER SHALL BE REDUCED TO 60 mm TO PROVIDE A CLEARANCE GAP OF 40mm. (REFER TO E2/AS1)
4. FOR ROOF PITCHES 8° OR GREATER. FOR LESSOR PITCHES USE INTERNAL GUTTER, OR REFER TO MRM CODE OF PRACTICE AS AN ALTERNATIVE TO THE ABOVE.
5. HIGH TO EXTRA HIGH WIND ZONE DOUBLE FIX UNDERFLASHINGS
6. FASTENERS TO BE COMPATIBLE WITH MATERIAL BEING FIXED AND THE SUITABLE GRADE FOR THE ENVIRONMENT IN WHICH LOCATED.
7. CLIPS OMITTED FOR CLARITY

GENERAL NOTES:

- These details are to be read with Roofing Industries SPANLOK™ Product Technical Statement and installation guide.
- These details are generally in compliance with E2/AS1 and/or the NZ Metal Roof & Wall Cladding Code of Practice and in some cases specific details by 'Roofing Industries'.
- The building designer is ultimately responsible to ensure that details used meet the requirements of the NZ Building Code for the specific project.
- Details of the supporting structure including cavity battens are indicative only and are the responsibility of the building designer. For steel framed buildings thermal break cavity battens may be required.
- Roof/wall underlay selection are the responsibility of the designer. Underlay to be installed in accordance with underlay manufacturer's recommendations and requirements.
- These details are for Roofing Industries profile/s as nominated and may not be applicable to other profiles.
- This drawing is the copyright of 'Roofing Industries' and can only be copied or reproduced with their permission.
- Further information can be obtained from the NZ Metal Roof & Wall Cladding Code of Practice: www.metalroofing.org.nz or E2/AS1.
- Details are for steel based materials, other substrates may require some changes.
- All dimensions are nominal.



Copyright detail © 2024

<http://wksp.nz/ri-esl-bar>



Get **WORKINGSPEC** from
Apple App Store/Google Play



EUROSTYLE SPANLOK™ VARIABLE PAN ROOFING ON PURLINS DORMER VALLEY DETAIL

Detail Number: RI-ESVPRRPUR-080B

Date drawn: 20/05/2024

Scale: 1 : 5@ A4

ROOFING INDUSTRIES
EUROSTYLE SPANLOK™ (7)

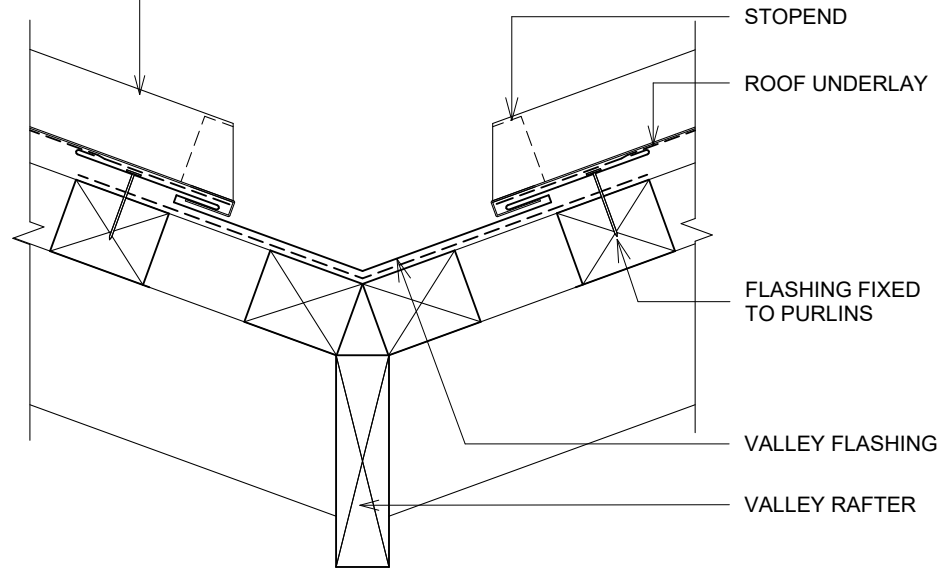

DETAIL ANNOTATION:

1. GUTTERS IN ACCORDANCE WITH NEW ZEALAND BUILDING CODE E2/AS1
2. RAINFALL INTENSITY WITH AVERAGE RECURRENCE INTERVAL (ARI) NO GREATER THAN 200mm PER HOUR
3. MINIMUM WIDTH OF VALLEY GUTTER MAY REDUCE TO 160mm, PROVIDING ROOF CATCHMENT AREA IS IN ACCORDANCE WITH THE TABLE ABOVE. IN THIS CASE, COVER OF ROOF CLADDING OVER GUTTER SHALL BE REDUCED TO 60 mm TO PROVIDE A CLEARANCE GAP OF 40mm. (REFER TO E2/AS1)
4. FOR ROOF PITCHES 8° OR GREATER. FOR LESSOR PITCHES USE INTERNAL GUTTER, OR REFER TO MRM CODE OF PRACTICE AS AN ALTERNATIVE TO THE ABOVE.
5. HIGH TO EXTRA HIGH WIND ZONE DOUBLE FIX UNDERFLASHINGS
6. FASTENERS TO BE COMPATABLE WITH MATERIAL BEING FIXED AND THE SUITABLE GRADE FOR THE ENVIRONMENT IN WHICH LOCATED.
7. CLIPS OMITTED FOR CLARITY

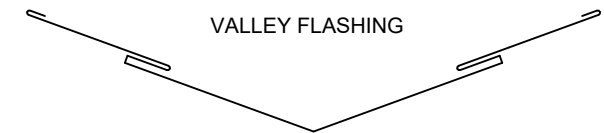

GENERAL NOTES:

- These details are to be read with Roofing Industries SPANLOK™ Product Technical Statement and installation guide.
- These details are generally in compliance with E2/AS1 and/or the NZ Metal Roof & Wall Cladding Code of Practice and in some cases specific details by 'Roofing Industries'.
- The building designer is ultimately responsible to ensure that details used meet the requirements of the NZ Building Code for the specific project.
- Details of the supporting structure including cavity battens are indicative only and are the responsibility of the building designer. For steel framed buildings thermal break cavity battens may be required.
- Roof/wall underlay selection are the responsibility of the designer. Underlay to be installed in accordance with underlay manufacturer's recommendations and requirements.
- These details are for Roofing Industries profile/s as nominated and may not be applicable to other profiles.
- This drawing is the copyright of 'Roofing Industries' and can only be copied or reproduced with their permission.
- Further information can be obtained from the NZ Metal Roof & Wall Cladding Code of Practice: www.metalroofing.org.nz or E2/AS1.
- Details are for steel based materials, other substrates may require some changes.
- All dimensions are nominal.



interactive assembly
instructions available

Copyright detail © 2024

<http://wksp.nz/ri-esl-bar>



Get **WORKINGSPEC** from
Apple App Store/Google Play



EUROSTYLE SPANLOK™ VARIABLE PAN ROOFING ON PURLINS INTERNAL GUTTER

Detail Number: RI-ESVPRRPUR-090

Date drawn: 20/05/2024

Scale: 1 : 5@ A4

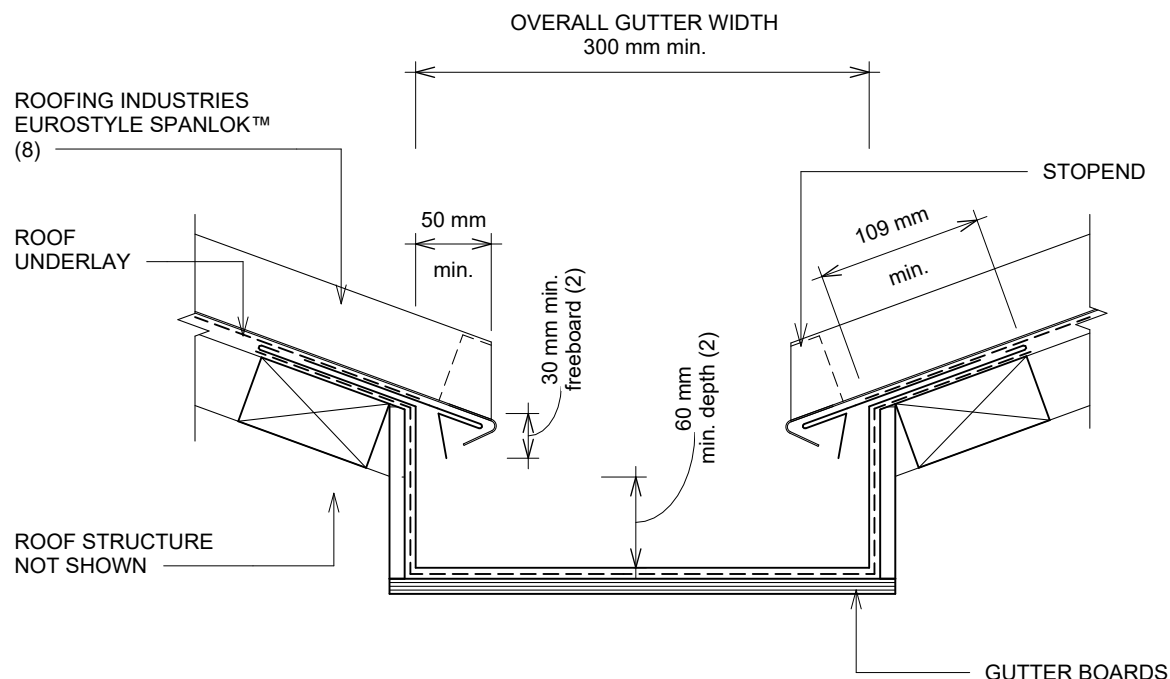

DETAIL ANNOTATION:

1. GUTTERS INSTALLED OVER ROOF UNDERLAY IF GUTTER BOARDS ARE TREATED TIMBER
2. INTERNAL GUTTER SHALL BE SIZED TO SUIT THE ROOF CATCHMENT AREA, BUT SHALL BE NO LESS THAN SHOWN IN THIS FIGURE. (REFER E2/AS1 FIG. 52)
3. INTERNAL GUTTER SHOULD BE MADE FROM NONFERROUS METAL'S COMPATIBLE WITH THE ROOFING MATERIAL.
4. GUTTER SIZES TO BE CALCULATED FROM E1/AS1
5. ALTERNATIVELY REFER TO MRM COP
6. HIGH TO EXTRA HIGH WIND ZONE DOUBLE FIX UNDERFLASHINGS
7. FASTENERS TO BE COMPATIBLE WITH MATERIAL BEING FIXED AND THE SUITABLE GRADE FOR THE ENVIRONMENT IN WHICH LOCATED.
8. CLIPS OMITTED FOR CLARITY

GENERAL NOTES:

- These details are to be read with Roofing Industries SPANLOK™ Product Technical Statement and installation guide.
- These details are generally in compliance with E2/AS1 and/or the NZ Metal Roof & Wall Cladding Code of Practice and in some cases specific details by 'Roofing Industries'.
- The building designer is ultimately responsible to ensure that details used meet the requirements of the NZ Building Code for the specific project.
- Details of the supporting structure including cavity battens are indicative only and are the responsibility of the building designer. For steel framed buildings thermal break cavity battens may be required.
- Roof/wall underlay selection are the responsibility of the designer. Underlay to be installed in accordance with underlay manufacturer's recommendations and requirements.
- These details are for Roofing Industries profile/s as nominated and may not be applicable to other profiles.
- This drawing is the copyright of 'Roofing Industries' and can only be copied or reproduced with their permission.
- Further information can be obtained from the NZ Metal Roof & Wall Cladding Code of Practice: www.metalroofing.org.nz or E2/AS1.
- Details are for steel based materials, other substrates may require some changes.
- All dimensions are nominal.

Copyright detail © 2024



EUROSTYLE SPANLOK™ VARIABLE PAN ROOFING ON PURLINS PARALLEL APRON FLASHING (NON CAVITY) TYPE 1, OPTION 1

Detail Number: RI-ESVPRRPUR-110A

Date drawn: 20/05/2024

Scale: 1 : 5@ A4

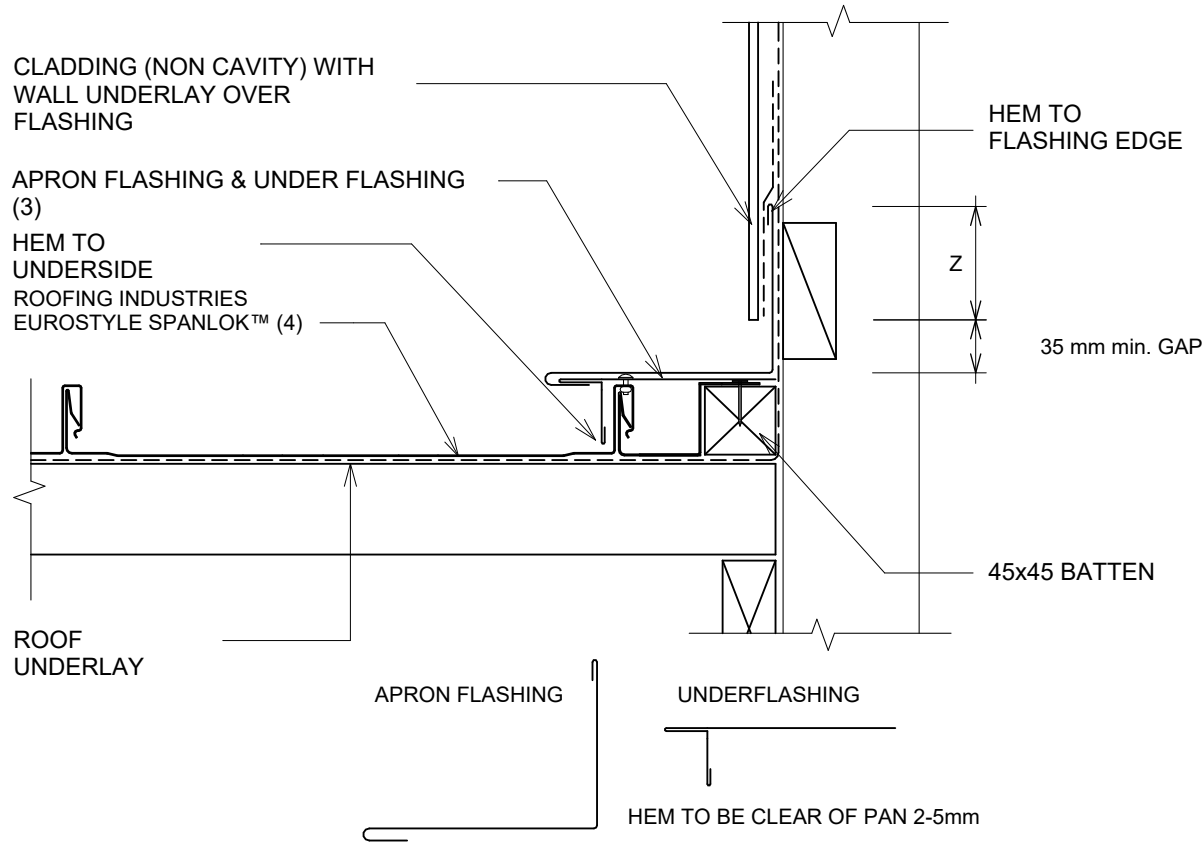

WIND ZONE	MINIMUM
	Z
SITUATION 1 & 2	75mm
SITUATION 3 (3)	100mm

DETAIL ANNOTATION:

1. SITUATION 1, 2 & 3 AS PER E2/AS1 TABLE 7
2. FASTENERS TO BE COMPATABLE WITH MATERIAL BEING FIXED AND THE SUITABLE GRADE FOR THE ENVIRONMENT IN WHICH LOCATED.
3. HIGH TO EXTRA HIGH WIND ZONE DOUBLE FIX UNDERFLASHINGS.
4. CLIPS OMITTED FOR CLARITY
5. TYPE 1 REFERS TO PURLINS, TYPE 2 REFERS TO PLYWOOD

GENERAL NOTES:

- These details are to be read with Roofing Industries SPANLOK™ Product Technical Statement and installation guide.
- These details are generally in compliance with E2/AS1 and/or the NZ Metal Roof & Wall Cladding Code of Practice and in some cases specific details by 'Roofing Industries'.
- The building designer is ultimately responsible to ensure that details used meet the requirements of the NZ Building Code for the specific project.
- Details of the supporting structure including cavity battens are indicative only and are the responsibility of the building designer. For steel framed buildings thermal break cavity battens may be required.
- Roof/wall underlay selection are the responsibility of the designer. Underlay to be installed in accordance with underlay manufacturer's recommendations and requirements.
- These details are for Roofing Industries profile/s as nominated and may not be applicable to other profiles.
- This drawing is the copyright of 'Roofing Industries' and can only be copied or reproduced with their permission.
- Further information can be obtained from the NZ Metal Roof & Wall Cladding Code of Practice: www.metalroofing.org.nz or E2/AS1.
- Details are for steel based materials, other substrates may require some changes.
- All dimensions are nominal.

Copyright detail © 2024



EUROSTYLE SPANLOK™ VARIABLE PAN ROOFING ON PURLINS PARALLEL APRON FLASHING (NON CAVITY) TYPE 1, OPTION 2

Detail Number: RI-ESVPRRPUR-110B

Date drawn: 20/05/2024

Scale: 1 : 5@ A4

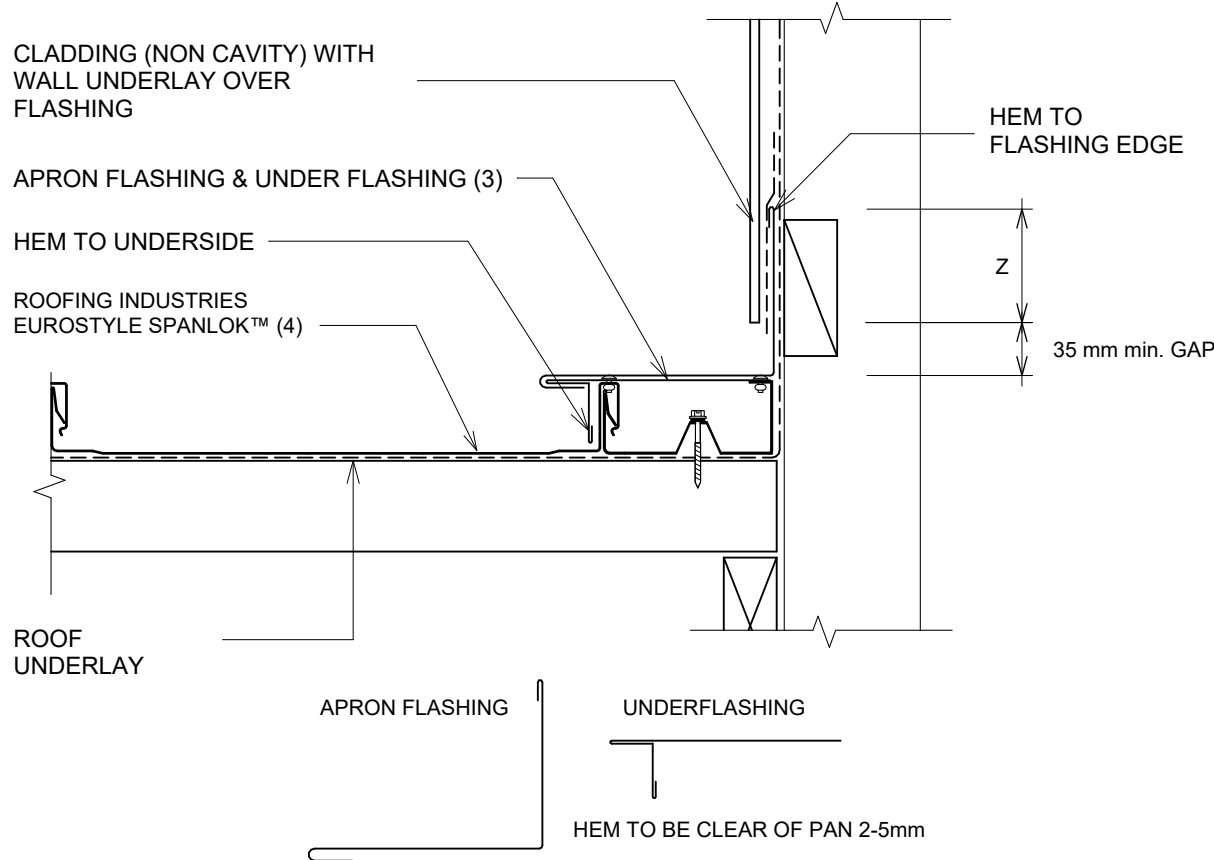

WIND ZONE	MINIMUM	
	Z	
SITUATION 1 & 2	75mm	
SITUATION 3 (3)	100mm	

DETAIL ANNOTATION:

1. SITUATION 1, 2 & 3 AS PER E2/AS1 TABLE 7
2. FASTENERS TO BE COMPATIBLE WITH MATERIAL BEING FIXED AND THE SUITABLE GRADE FOR THE ENVIRONMENT IN WHICH LOCATED.
3. HIGH TO EXTRA HIGH WIND ZONE DOUBLE FIX UNDERFLASHINGS.
4. CLIPS OMITTED FOR CLARITY
5. TYPE 1 REFERS TO PURLINS, TYPE 2 REFERS TO PLYWOOD

GENERAL NOTES:

- These details are to be read with Roofing Industries SPANLOK™ Product Technical Statement and installation guide.
- These details are generally in compliance with E2/AS1 and/or the NZ Metal Roof & Wall Cladding Code of Practice and in some cases specific details by 'Roofing Industries'.
- The building designer is ultimately responsible to ensure that details used meet the requirements of the NZ Building Code for the specific project.
- Details of the supporting structure including cavity battens are indicative only and are the responsibility of the building designer. For steel framed buildings thermal break cavity battens may be required.
- Roof/wall underlay selection are the responsibility of the designer. Underlay to be installed in accordance with underlay manufacturer's recommendations and requirements.
- These details are for Roofing Industries profile/s as nominated and may not be applicable to other profiles.
- This drawing is the copyright of 'Roofing Industries' and can only be copied or reproduced with their permission.
- Further information can be obtained from the NZ Metal Roof & Wall Cladding Code of Practice: www.metalroofing.org.nz or E2/AS1.
- Details are for steel based materials, other substrates may require some changes.
- All dimensions are nominal.

Copyright detail © 2024



EUROSTYLE SPANLOK™ VARIABLE PAN ROOFING ON PURLINS PARALLEL APRON FLASHING (CAVITY) TYPE 1, OPTION 1

Detail Number: RI-ESVPRRPUR-110C

Date drawn: 20/05/2024

Scale: 1 : 5@ A4

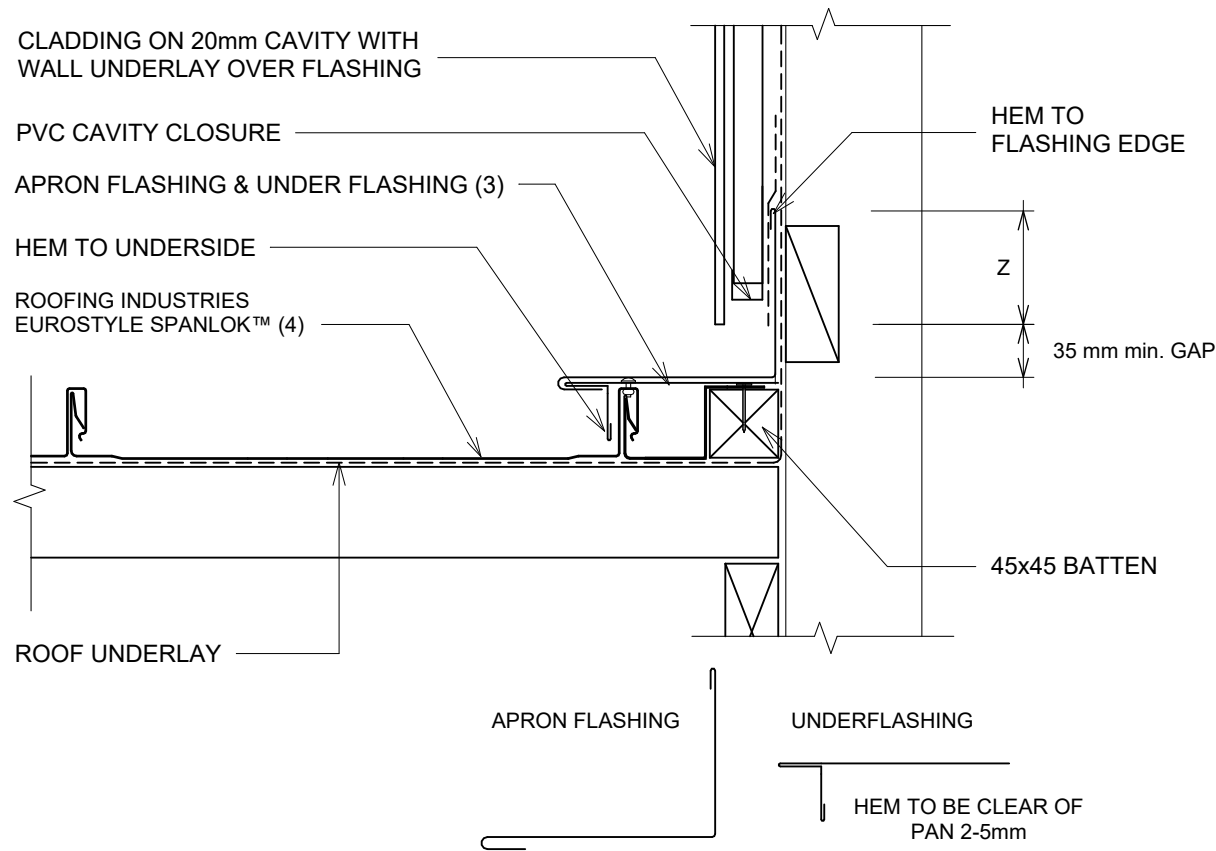

WIND ZONE	MINIMUM	
	Z	
SITUATION 1 & 2	75mm	
SITUATION 3 (3)	100mm	

DETAIL ANNOTATION:

1. SITUATION 1, 2 & 3 AS PER E2/AS1 TABLE 7
2. FASTENERS TO BE COMPATIBLE WITH MATERIAL BEING FIXED AND THE SUITABLE GRADE FOR THE ENVIRONMENT IN WHICH LOCATED.
3. HIGH TO EXTRA HIGH WIND ZONE DOUBLE FIX UNDERFLASHINGS.
4. CLIPS OMITTED FOR CLARITY
5. TYPE 1 REFERS TO PURLINS, TYPE 2 REFERS TO PLYWOOD

GENERAL NOTES:

- These details are to be read with Roofing Industries SPANLOK™ Product Technical Statement and installation guide.
- These details are generally in compliance with E2/AS1 and/or the NZ Metal Roof & Wall Cladding Code of Practice and in some cases specific details by 'Roofing Industries'.
- The building designer is ultimately responsible to ensure that details used meet the requirements of the NZ Building Code for the specific project.
- Details of the supporting structure including cavity battens are indicative only and are the responsibility of the building designer. For steel framed buildings thermal break cavity battens may be required.
- Roof/wall underlay selection are the responsibility of the designer. Underlay to be installed in accordance with underlay manufacturer's recommendations and requirements.
- These details are for Roofing Industries profile/s as nominated and may not be applicable to other profiles.
- This drawing is the copyright of 'Roofing Industries' and can only be copied or reproduced with their permission.
- Further information can be obtained from the NZ Metal Roof & Wall Cladding Code of Practice: www.metalroofing.org.nz or E2/AS1.
- Details are for steel based materials, other substrates may require some changes.
- All dimensions are nominal.

Copyright detail © 2024



EUROSTYLE SPANLOK™ VARIABLE PAN ROOFING ON PURLINS PARALLEL APRON FLASHING (CAVITY) TYPE 1, OPTION 2

Detail Number: RI-ESVPRRPUR-110D

Date drawn: 20/05/2024

Scale: 1 : 5@ A4

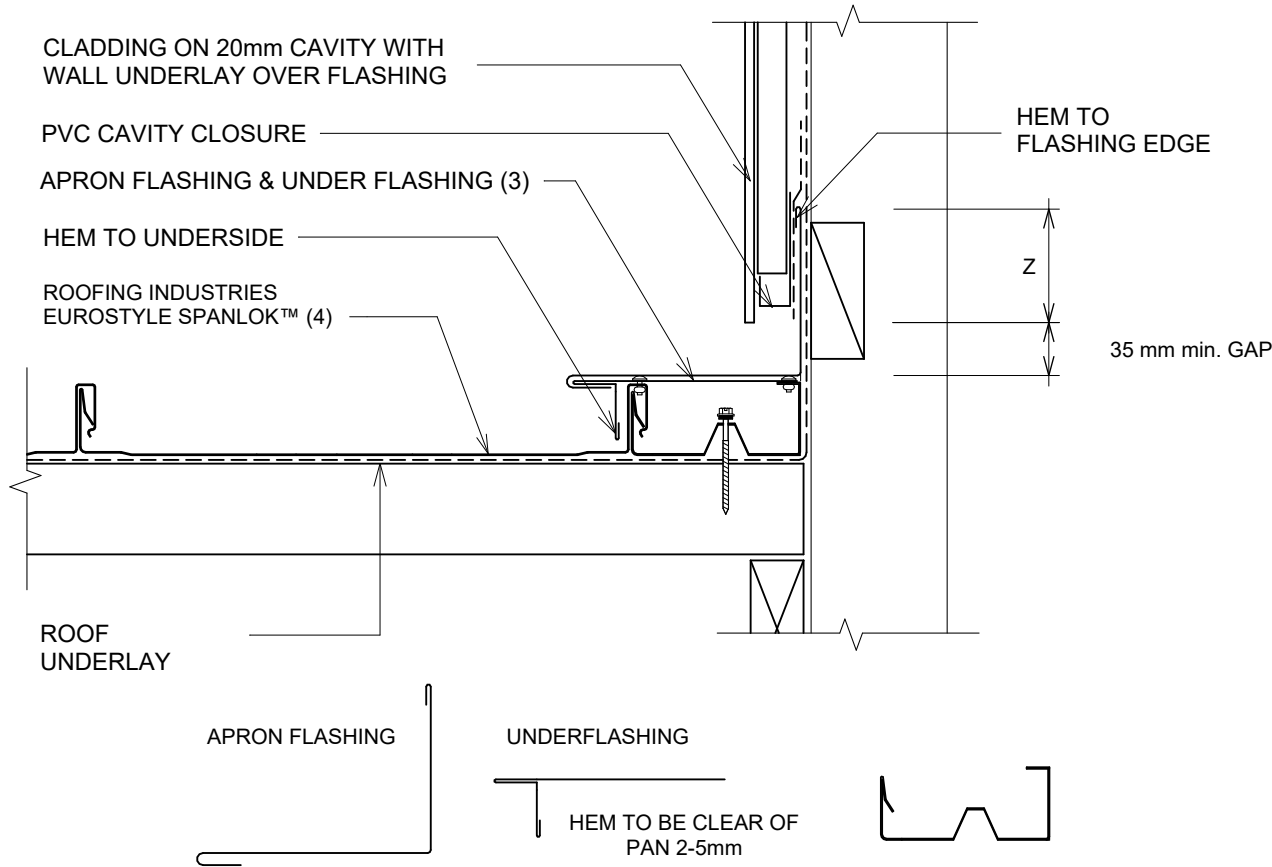

WIND ZONE	MINIMUM
	Z
SITUATION 1 & 2	75mm
SITUATION 3 (3)	100mm

DETAIL ANNOTATION:

1. SITUATION 1, 2 & 3 AS PER E2/AS1 TABLE 7
2. FASTENERS TO BE COMPATIBLE WITH MATERIAL BEING FIXED AND THE SUITABLE GRADE FOR THE ENVIRONMENT IN WHICH LOCATED.
3. HIGH TO EXTRA HIGH WIND ZONE DOUBLE FIX UNDERFLASHINGS.
4. CLIPS OMITTED FOR CLARITY
TYPE 1 REFERS TO PURLINS, TYPE 2 REFERS TO PLYWOOD
- 5.

GENERAL NOTES:

- These details are to be read with Roofing Industries SPANLOK™ Product Technical Statement and installation guide.
- These details are generally in compliance with E2/AS1 and/or the NZ Metal Roof & Wall Cladding Code of Practice and in some cases specific details by 'Roofing Industries'.
- The building designer is ultimately responsible to ensure that details used meet the requirements of the NZ Building Code for the specific project.
- Details of the supporting structure including cavity battens are indicative only and are the responsibility of the building designer. For steel framed buildings thermal break cavity battens may be required.
- Roof/wall underlay selection are the responsibility of the designer. Underlay to be installed in accordance with underlay manufacturer's recommendations and requirements.
- These details are for Roofing Industries profile/s as nominated and may not be applicable to other profiles.
- This drawing is the copyright of 'Roofing Industries' and can only be copied or reproduced with their permission.
- Further information can be obtained from the NZ Metal Roof & Wall Cladding Code of Practice: www.metalroofing.org.nz or E2/AS1.
- Details are for steel based materials, other substrates may require some changes.
- All dimensions are nominal.



interactive assembly
instructions available

Copyright detail © 2024

<http://wksp.nz/ri-esl-bar>



Get WORKINGSPEC from
Apple App Store/Google Play



EUROSTYLE SPANLOK™ VARIABLE PAN ROOFING ON PURLINS TYPICAL APRON FLASHING (CAVITY) TYPE 1

Detail Number: RI-ESVPRRPUR-120A

Date drawn: 20/05/2024

Scale: 1 : 5@ A4

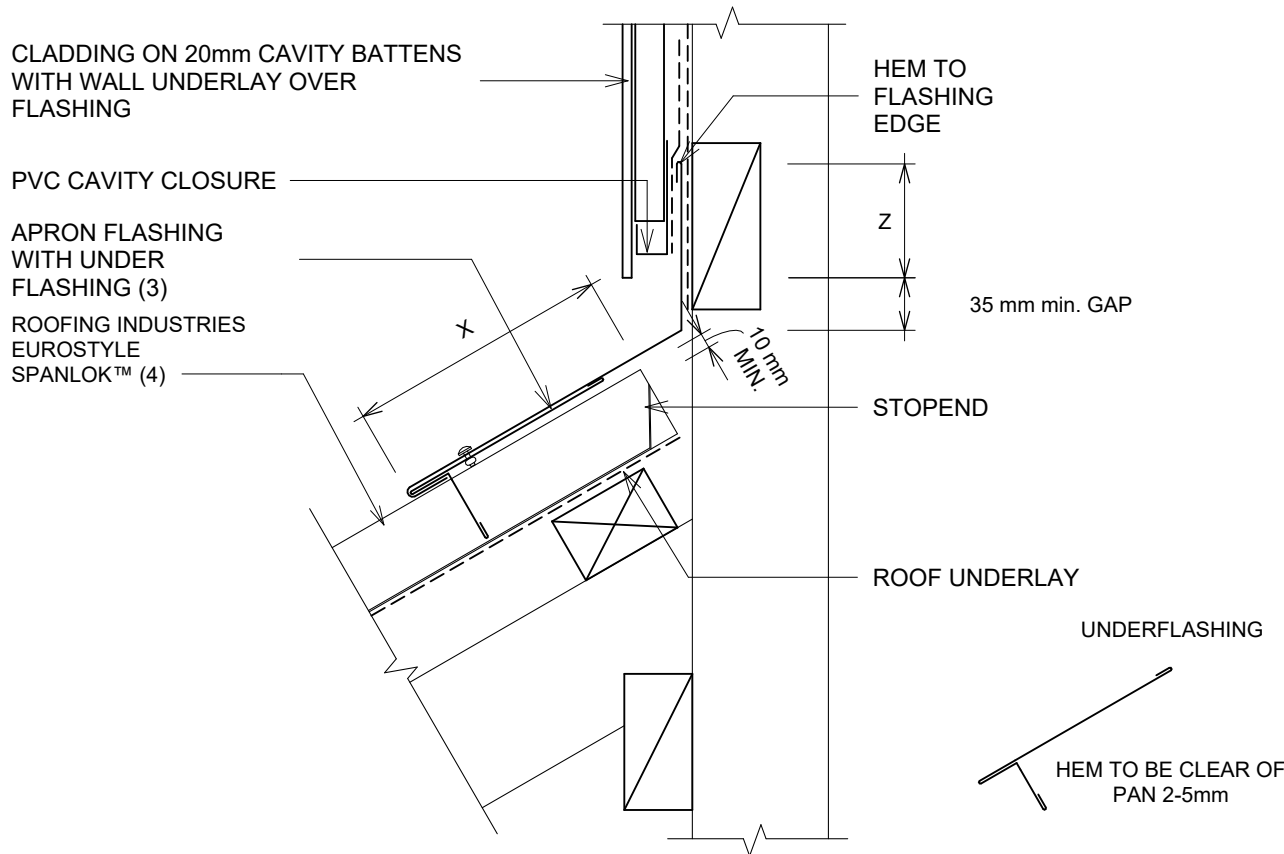

WIND ZONE	MINIMUM	
	Z	X
SITUATION 1	75mm	130mm
SITUATION 2	90mm	200mm
SITUATION 3 (5)	100mm	200mm

DETAIL ANNOTATION:

DESIGNER TO ENSURE DURABILITY OF FLASHING MATERIAL;

1. SITUATION 1, 2 & 3 AS PER E2/AS1 TABLE 7
2. FASTENERS TO BE COMPATIBLE WITH MATERIAL BEING FIXED AND THE SUITABLE GRADE FOR THE ENVIRONMENT IN WHICH LOCATED.
3. HIGH TO EXTRA HIGH WIND ZONE DOUBLE FIX UNDERFLASHINGS.
4. CLIPS OMITTED FOR CLARITY
5. ALTERNATIVELY REFER TO E2/AS1
6. TYPE 1 REFERS TO PURLINS, TYPE 2 REFERS TO PLYWOOD

GENERAL NOTES:

- These details are to be read with Roofing Industries SPANLOK™ Product Technical Statement and installation guide.
- These details are generally in compliance with E2/AS1 and/or the NZ Metal Roof & Wall Cladding Code of Practice and in some cases specific details by 'Roofing Industries'.
- The building designer is ultimately responsible to ensure that details used meet the requirements of the NZ Building Code for the specific project.
- Details of the supporting structure including cavity battens are indicative only and are the responsibility of the building designer. For steel framed buildings thermal break cavity battens may be required.
- Roof/wall underlay selection are the responsibility of the designer. Underlay to be installed in accordance with underlay manufacturer's recommendations and requirements.
- These details are for Roofing Industries profile/s as nominated and may not be applicable to other profiles.
- This drawing is the copyright of 'Roofing Industries' and can only be copied or reproduced with their permission.
- Further information can be obtained from the NZ Metal Roof & Wall Cladding Code of Practice: www.metalroofing.org.nz or E2/AS1.
- Details are for steel based materials, other substrates may require some changes.
- All dimensions are nominal.

Copyright detail © 2024



EUROSTYLE SPANLOK™ VARIABLE PAN ROOFING ON PURLINS TYPICAL APRON FLASHING (NON CAVITY) TYPE 1

Detail Number: RI-ESVPRRPUR-120B

Date drawn: 20/05/2024

Scale: 1 : 5@ A4

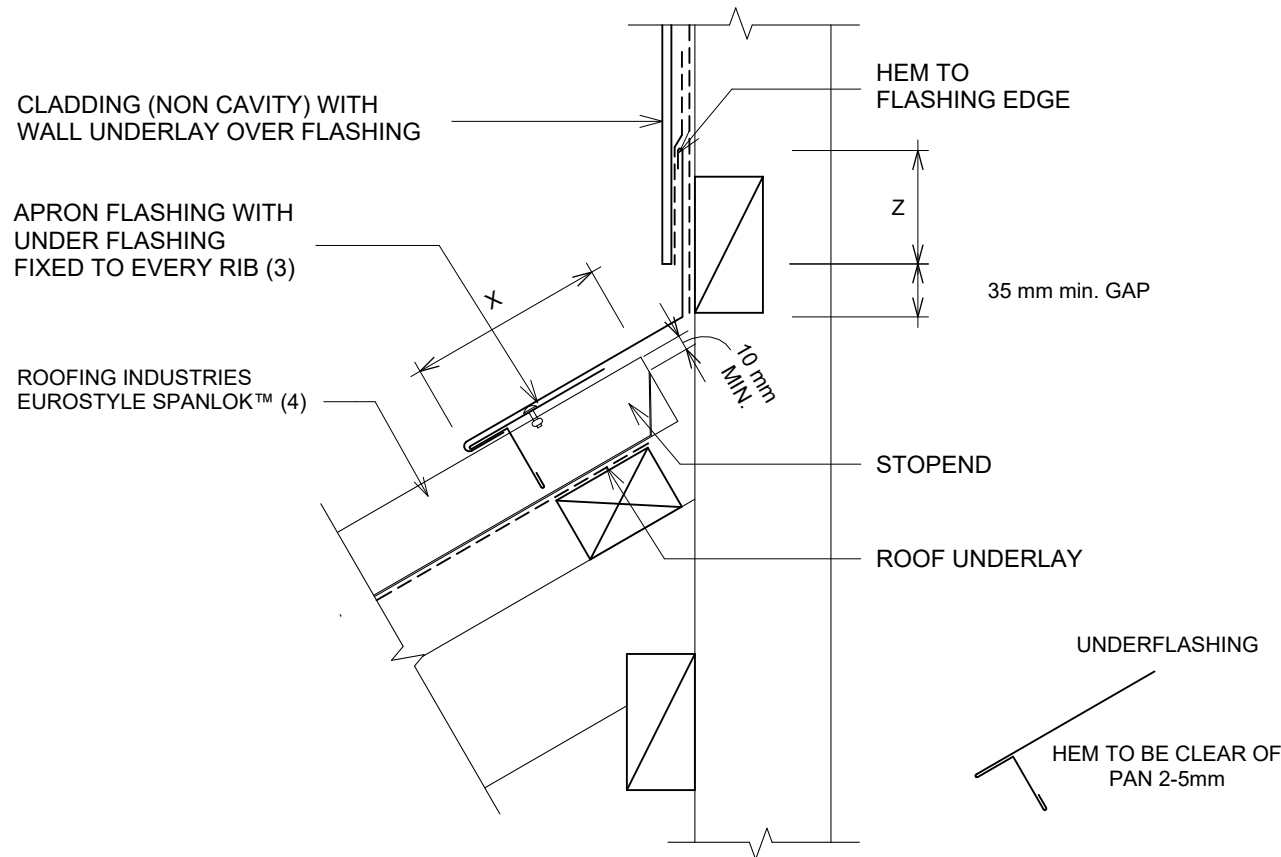

WIND ZONE	MINIMUM	
	Z	X
SITUATION 1	75mm	130mm
SITUATION 2	90mm	200mm
SITUATION 3 (5)	100mm	200mm

DETAIL ANNOTATION:

DESIGNER TO ENSURE DURABILITY OF FLASHING MATERIAL;

1. SITUATION 1, 2 & 3 AS PER E2/AS1 TABLE 7
2. FASTENERS TO BE COMPATIBLE WITH MATERIAL BEING FIXED AND THE SUITABLE GRADE FOR THE ENVIRONMENT IN WHICH LOCATED.
3. HIGH TO EXTRA HIGH WIND ZONE DOUBLE FIX UNDERFLASHINGS.
4. CLIPS OMITTED FOR CLARITY
5. ALTERNATIVELY REFER TO E2/AS1
6. TYPE 1 REFERS TO PURLINS, TYPE 2 REFERS TO PLYWOOD

GENERAL NOTES:

- These details are to be read with Roofing Industries SPANLOK™ Product Technical Statement and installation guide.
- These details are generally in compliance with E2/AS1 and/or the NZ Metal Roof & Wall Cladding Code of Practice and in some cases specific details by 'Roofing Industries'.
- The building designer is ultimately responsible to ensure that details used meet the requirements of the NZ Building Code for the specific project.
- Details of the supporting structure including cavity battens are indicative only and are the responsibility of the building designer. For steel framed buildings thermal break cavity battens may be required.
- Roof/wall underlay selection are the responsibility of the designer. Underlay to be installed in accordance with underlay manufacturer's recommendations and requirements.
- These details are for Roofing Industries profile/s as nominated and may not be applicable to other profiles.
- This drawing is the copyright of 'Roofing Industries' and can only be copied or reproduced with their permission.
- Further information can be obtained from the NZ Metal Roof & Wall Cladding Code of Practice: www.metalroofing.org.nz or E2/AS1.
- Details are for steel based materials, other substrates may require some changes.
- All dimensions are nominal.

Copyright detail © 2024



EUROSTYLE SPANLOK™ VARIABLE PAN ROOFING ON PURLINS PIPE PENETRATION 2 (MID PAN)

Detail Number: RI-ESVPRRPUR-160A

Date drawn: 20/05/2024

Scale: 1 : 10@ A4

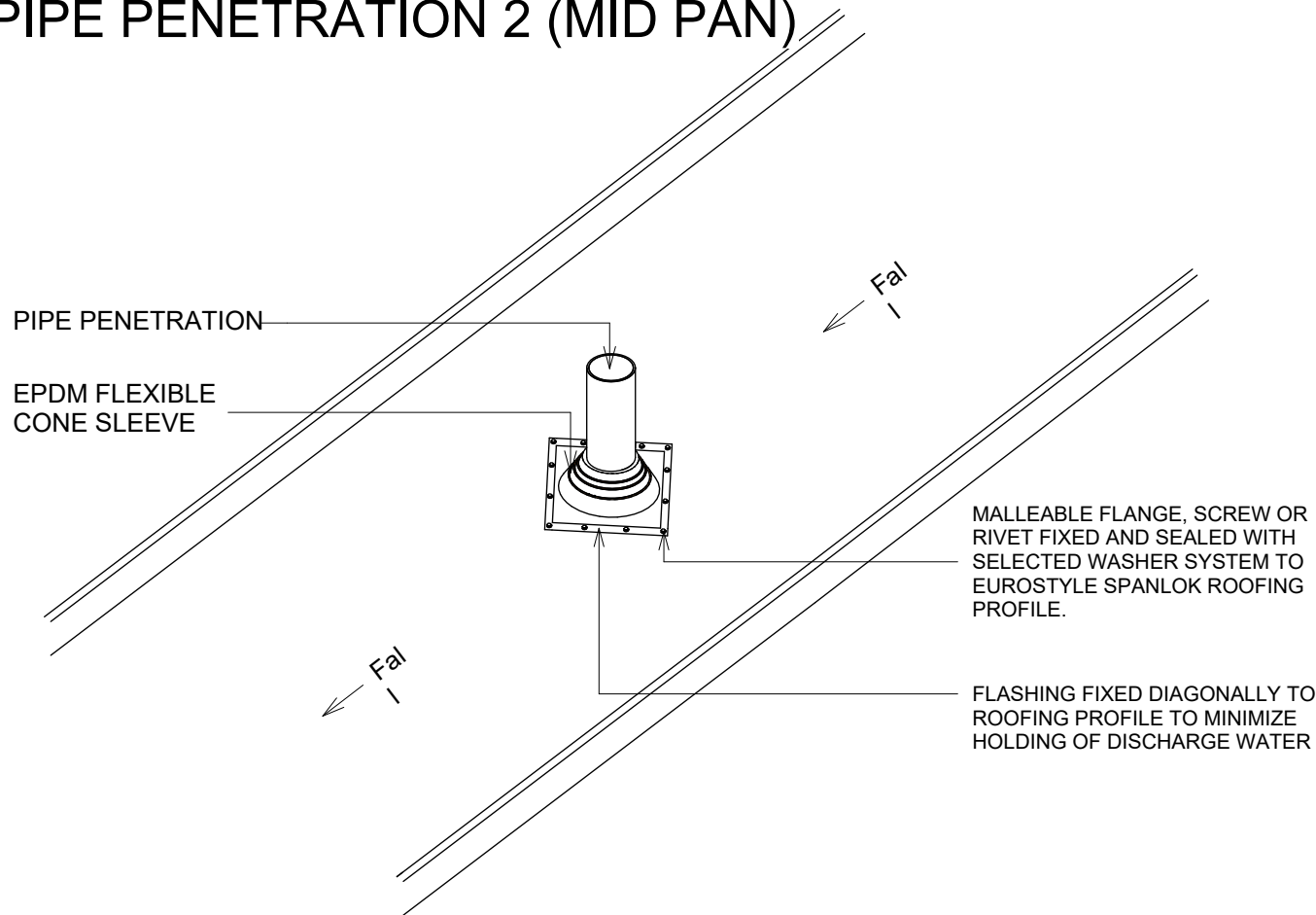

DETAIL ANNOTATION:

1. INDICATIVE STRUCTURE SHOWN FOR ILLUSTRATION PURPOSES ONLY
2. CONFIRMATION REQUIRED OF THICKNESS AND COATING TO CLADDING/FLASHING
3. REFER TO PROFILE TECHNICAL SUMMARY FOR FIXING REQUIREMENTS
4. SUITABLE FOR PIPES UP TO 85mm DIAMETER
5. MAX ROOF PITCH FOR FLASHING IS 45°, MINIMUM PITCH IS 10° IF BASE OF FLANGE COVERS ONE OR MORE COMPLETE TROUGHS.
6. WHERE THE BASE OF A BOOT DOES NOT OBSTRUCT A PAN IT CAN BE DIRECT-FIXED TO THE MINIMUM PITCH FOR THAT PROFILE.
7. WHERE OVERALL WIDTH IS NOT A CONSTRAINT, DIRECTLY FIXED BOOT FLASHINGS SHOULD BE INSTALLED WITH THEIR EDGES DIAGONAL TO THE FALL OF WATER. WHERE THIS IS NOT PRACTICAL, THEY MAY BE LAID SQUARE AT PITCHES OF 10° OR MORE.
8. REFER TO NZ METAL ROOF AND WALL CLADDING CODE OF PRACTICE V3.0

GENERAL NOTES:

- These details are to be read with Roofing Industries SPANLOK™ Product Technical Statement and installation guide.
- These details are generally in compliance with E2/AS1 and/or the NZ Metal Roof & Wall Cladding Code of Practice and in some cases specific details by 'Roofing Industries'.
- The building designer is ultimately responsible to ensure that details used meet the requirements of the NZ Building Code for the specific project.
- Details of the supporting structure including cavity battens are indicative only and are the responsibility of the building designer. For steel framed buildings thermal break cavity battens may be required.
- Roof/wall underlay selection are the responsibility of the designer. Underlay to be installed in accordance with underlay manufacturer's recommendations and requirements.
- These details are for Roofing Industries profile/s as nominated and may not be applicable to other profiles.
- This drawing is the copyright of 'Roofing Industries' and can only be copied or reproduced with their permission.
- Further information can be obtained from the NZ Metal Roof & Wall Cladding Code of Practice: www.metalroofing.org.nz or E2/AS1.
- Details are for steel based materials, other substrates may require some changes.
- All dimensions are nominal.



interactive assembly
instructions available

Copyright detail © 2024

<http://wksp.nz/ri-esl-bar>



Get **WORKINGSPEC** from
Apple App Store/Google Play



EUROSTYLE SPANLOK™ VARIABLE PAN ROOFING ON PURLINS PIPE PENETRATION AT GUTTER EDGE

Detail Number: RI-ESVPRRPUR-160B

Date drawn: 20/05/2024

Scale: 1 : 10@ A4

GRAB FLASHING
SILICONE AND SEAL

PIPE PENETRATION

EAVE BOOT FLASHING ON
EURO STYLE SPANLOK

FLAT PAN

GRAB FLASHING

FLASHING LINE LAPPED
UNDERNEATH ROOFING

STOP END
RIB

SEAL END LAPS WITH LAP
SEAL TAPE OR SEALANT

DETAIL ANNOTATION:

1. WHERE END LAPS ARE UNAVOIDABLE, A SEALED JOINT SHOULD BE MADE USING SEALANT AT BOTH ENDS OF THE LAP.
2. THE UPPER SEAL IS CRITICAL AS CONDENSATION ENTERING THE UPPER SIDE OF THE LAP FROM UNDERNEATH CAN CAUSE RAPID CORROSION.

GENERAL NOTES:

- These details are to be read with Roofing Industries SPANLOK™ Product Technical Statement and installation guide.
- These details are generally in compliance with E2/AS1 and/or the NZ Metal Roof & Wall Cladding Code of Practice and in some cases specific details by 'Roofing Industries'.
- The building designer is ultimately responsible to ensure that details used meet the requirements of the NZ Building Code for the specific project.
- Details of the supporting structure including cavity battens are indicative only and are the responsibility of the building designer. For steel framed buildings thermal break cavity battens may be required.
- Roof/wall underlay selection are the responsibility of the designer. Underlay to be installed in accordance with underlay manufacturer's recommendations and requirements.
- These details are for Roofing Industries profile/s as nominated and may not be applicable to other profiles.
- This drawing is the copyright of 'Roofing Industries' and can only be copied or reproduced with their permission.
- Further information can be obtained from the NZ Metal Roof & Wall Cladding Code of Practice: www.metalroofing.org.nz or E2/AS1.
- Details are for steel based materials, other substrates may require some changes.
- All dimensions are nominal.

Copyright detail © 2024



EUROSTYLE SPANLOK™ VARIABLE PAN ROOFING ON PURLINS PENETRATION FLASHING DETAILS

Detail Number: RI-ESVPRRPUR-190

Date drawn: 20/05/2024

Scale: 1 : 5@ A2

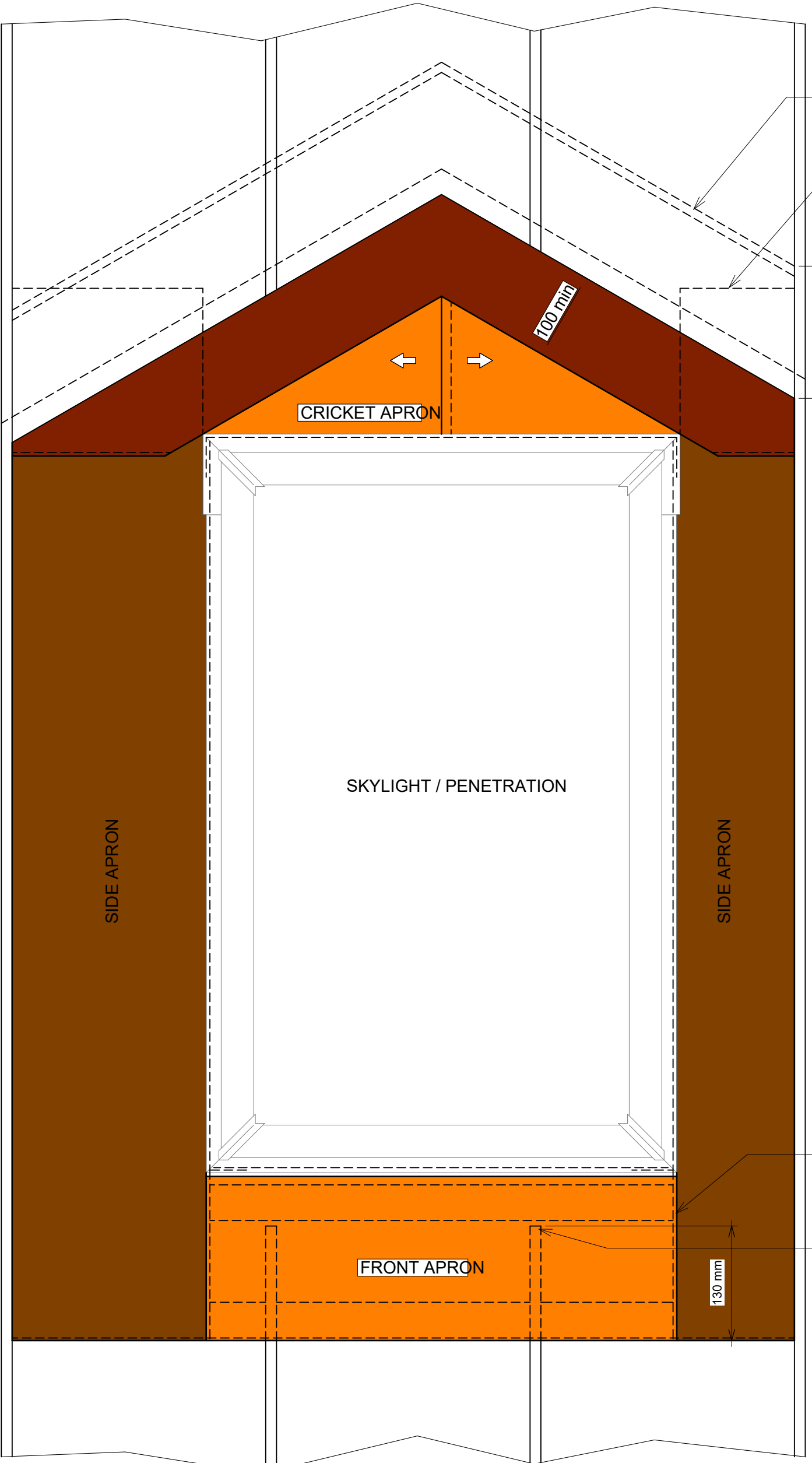

TOP OF CRICKET FLASHING BACKTRAY, 10mm HEM

SIDE APRON FLASHING UNDER PENETRATION FLASHING

150 mm

CRICKET APRON

SKYLIGHT / PENETRATION

SIDE APRON

SIDE APRON

FRONT APRON

130 mm

UNDER FLASHING FIXED TO PURLINS AT 200crs MAX

EUROSTYLE SPANLOK™ WITH STOP END

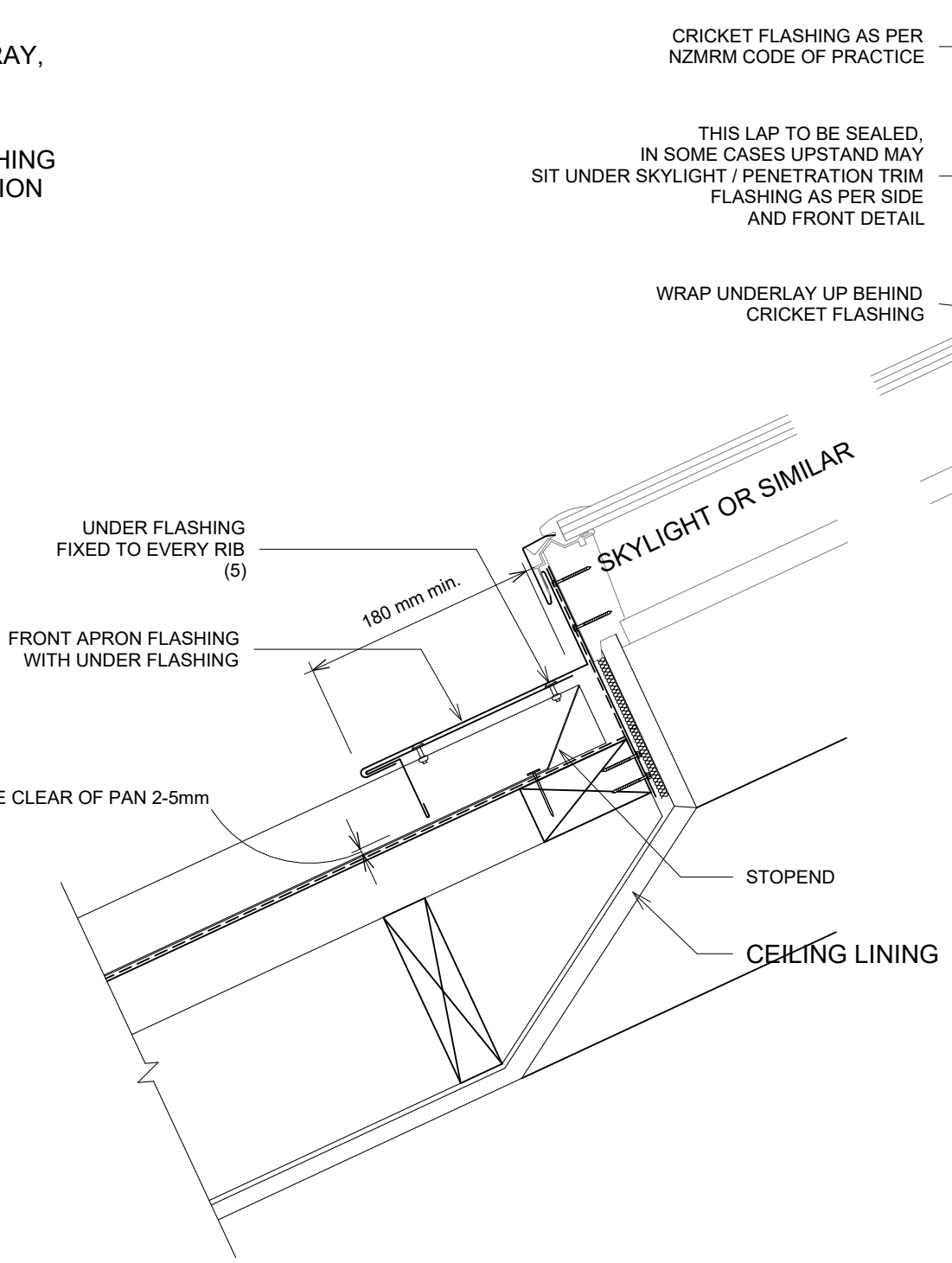

CRICKET FLASHING AS PER NZMRM CODE OF PRACTICE

THIS LAP TO BE SEALED, IN SOME CASES UPSTAND MAY SIT UNDER SKYLIGHT / PENETRATION TRIM FLASHING AS PER SIDE AND FRONT DETAIL

WRAP UNDERLAY UP BEHIND CRICKET FLASHING

UNDER FLASHING FIXED TO EVERY RIB (5)

FRONT APRON FLASHING WITH UNDER FLASHING

HEM TO BE CLEAR OF PAN 2-5mm

SKYLIGHT OR SIMILAR

STOPEND

CEILING LINING

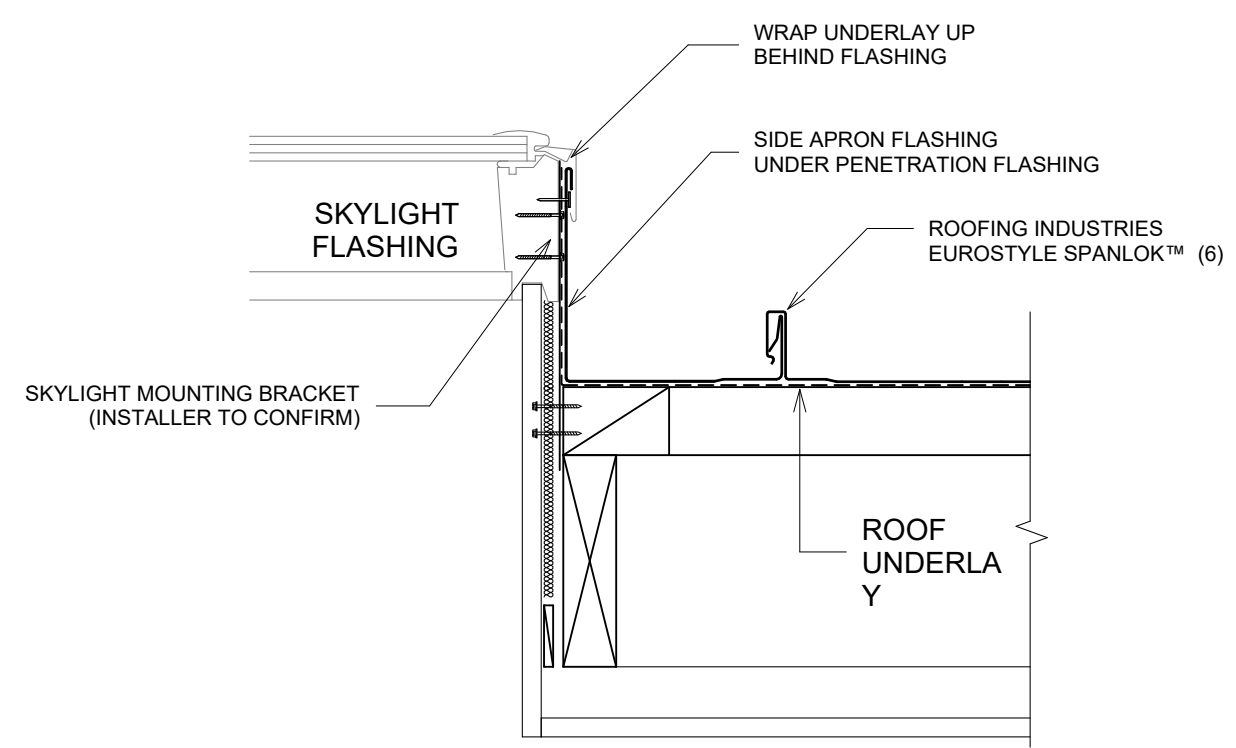

WRAP UNDERLAY UP BEHIND FLASHING

SIDE APRON FLASHING UNDER PENETRATION FLASHING

ROOFING INDUSTRIES EUROSTYLE SPANLOK™ (6)

SKYLIGHT MOUNTING BRACKET (INSTALLER TO CONFIRM)

ROOF UNDERLAY

- DETAIL ANNOTATION:**
1. REFER TO NZMRM CODE OF PRACTICE FOR CATCHMENT AREA LIMITATIONS.
 2. REFER TO NZMRM CODE OF PRACTICE FOR FURTHER INFORMATION.
 3. REFER TO SKYLIGHT MANUFACTURERS DETAILS AS SOME LOW PITCH INSTALLATIONS REQUIRE MODIFICATIONS TO THESE DETAILS.
 4. SKYLIGHT MOUNTING BRACKETS ARE INDICATIVE ONLY AND DIFFERENT SKYLIGHTS / PENETRATIONS MAY REQUIRE DIFFERENT FRAMING, MOUNTING AND FLASHING DETAILS.
 5. HIGH TO EXTRA HIGH WIND ZONE DOUBLE RIVET CLIPS OMITTED FOR CLARITY
 6. CLIPS OMITTED FOR CLARITY

- GENERAL NOTES:**
- These details are to be read with Roofing Industries profile technical summary regarding wind loads and fixings.
 - These details are generally in compliance with E2/AS1 and/or the NZ Metal Roof & Wall Cladding Code of Practice and in some cases specific details by 'Roofing Industries'.
 - The building designer is ultimately responsible to ensure that details used meet the requirements of the NZ Building Code for the specific project.
 - Details of the supporting structure including cavity battens are indicative only and are the responsibility of the building designer. For steel framed buildings thermal break cavity battens may be required.
 - Roof/wall underlay selection are the responsibility of the designer. Underlay to be installed in accordance with underlay manufacturer's recommendations and requirements.
 - These details are for Roofing Industries profile/s as nominated and may not be applicable to other profiles.
 - This drawing is the copyright of 'Roofing Industries' and can only be copied or reproduced with their permission.
 - Further information can be obtained from the NZ Metal Roof & Wall Cladding Code of Practice: www.metalroofing.org.nz or E2/AS1.
 - Details are for steel based materials, other substrates may require some changes.
 - All dimensions are nominal.

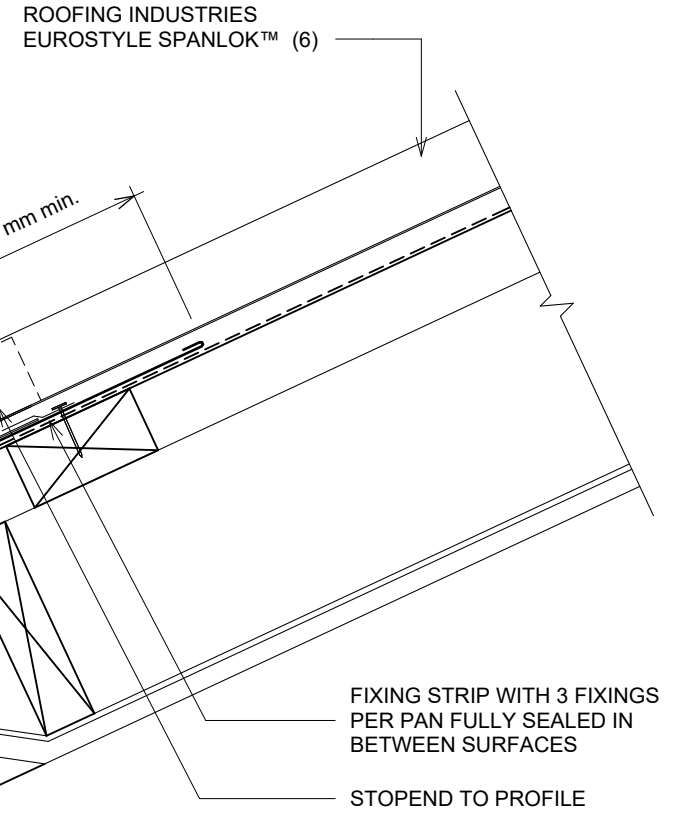

ROOFING INDUSTRIES EUROSTYLE SPANLOK™ (6)

FIXING STRIP WITH 3 FIXINGS PER PAN FULLY SEALED IN BETWEEN SURFACES

STOPEND TO PROFILE

interactive assembly instructions available

<http://wksp.nz/ri-esl-srp>



Get WORKINGSPEC from Apple App Store/Google Play

Copyright detail © 2024

