

# COMMERCIAL WINDOW / DOOR JAMB FLASHING FOR TRIMRIB VERTICAL CLADDING (Recessed Window/Door)

DETAIL NO. CTW012B  
DATE DRAWN 16/08/12  
FILE REFERENCE RI-CTW012B.DWG

BUILDING WRAP DRESSED INTO  
OPENING WITH 50mm RETURN  
TO INSIDE OF FRAME WITH  
WINDOW FLASHING TAPE  
INSTALLED OVER  
WRAP TO CORNERS

ROOFING INDUSTRIES BACK  
TRAY\* FLASHING RUN FROM  
TOP OF HEAD FLASHING TO  
GROUND OR EXIT POINT

ROOFING INDUSTRIES  
TRIMRIB

GAP 5mm MAX TO CLEAR  
OF PAN OF CLADDING

CONTINUOUS COMPRESSIBLE  
FOAM SEAL

SCREW FIXING

ROOFING INDUSTRIES JAMB  
FLASHING

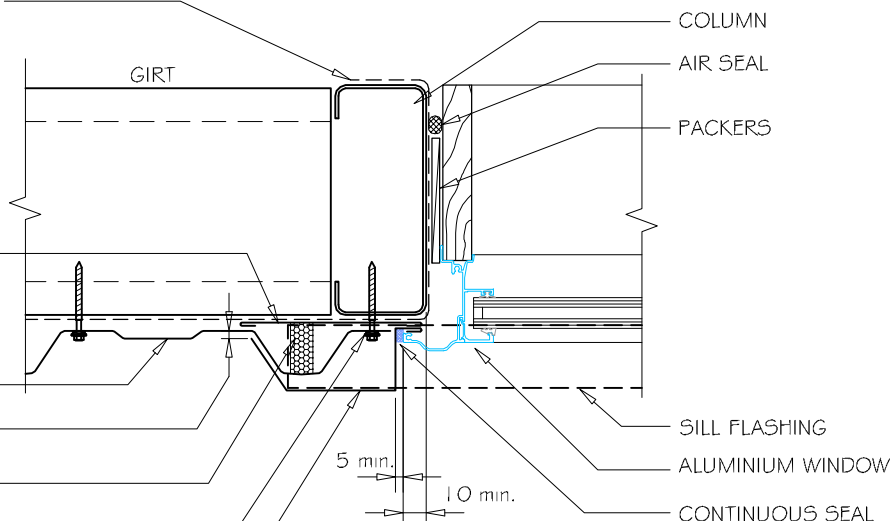

## GENERAL NOTES:

- (1) REFER TO E2/AS1 OR WNZ WIS FOR GENERAL WINDOW OPENING FOR WRAPPING OF FRAMED OPENING PRIOR TO WINDOW INSTALLATION.
- (2) WINDOW PROFILE TO BE SELECTED TO ACHIEVE COVER SHOWN IN DETAILS.
- (3) ARCHITRAVES ARE SHOWN FOR CONSISTENCY ONLY, DETAIL MAY BE USED WITH REBATED LINER.
- (4) WHERE SUPPORT BRACKETS ARE REQUIRED BY THE WINDOW MANUFACTURER TO CARRY THE FRAME AND GLAZING LOADS THEY MUST BE SUPPLIED AS AN INTEGRAL PART OF THE WINDOW MANUFACTURER'S RECOMMENDATIONS.
- (5) LIASE WITH WINDOW MANUFACTURER PRIOR TO INSTALLATION.

## REFERENCE FLASHINGS:

NZ METAL ROOF AND WALL CLADDING  
CODE OF PRACTICE NZMRM.  
WNZ WIS.  
DIMENSIONS ARE INDICATIVE ONLY

**B** WINDOW JAMB VERTICAL TRIMRIB  
1:5

## NOTES:

- These details are generally in compliance with the NZ Metal Roof & Wall Cladding Code of Practice and in some cases specific details by 'Roofing Industries'.
- The building designer is ultimately responsible to ensure that details used meet the requirements of the NZ Building Code for the specific project.
- Details of the supporting structure are indicative only and are the responsibility of the building designer.
- Thermal break or cavity battens may be required in some circumstances.
- Underlay selection and building wrap types are the responsibility of the designer, Alternative support to galvanised netting should be used in severe coastal environments including when aluminium is used.
- These details are for Roofing Industries profile/s as nominated and may not be applicable to other profiles.
- This drawing is the copyright of 'Roofing Industries' and can only be copied or reproduced with their permission.
- Further information can be obtained from the NZ Metal Roof & Wall Cladding Code of Practice [www.metalroofer.org.nz](http://www.metalroofer.org.nz) & [www.roof.co.nz](http://www.roof.co.nz)
- Where necessary adjust drawings for purlin battens or cavity battens.
- Details are for steel based materials, other substrate may require some changes.

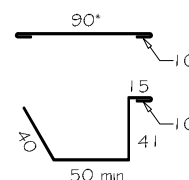

\* Back tray size may require to increase to ensure coverage at ends of head flashings.  
(Dimensions are indicative only)  
Turn down end of head flashing

©COPYRIGHT DETAIL 2012

