

# Installation Instructions

## Carpet Tiles & Planks

1/4

### Upon Receipt

A pallet can hold up to 20 boxes. To prevent damage, do not double stack pallets. Each box has a batch number; ensure all tiles are from the same batch before installation, as mixing batches may lead to slight colour variations.

### Preparation for Carpet Tile Installation

#### Conditioning

Prior to installation, it's essential to condition the site. Ensure that all exterior windows and doors are properly sealed before starting the installation process or any floor preparations.

#### Site Conditions

The site and floors must meet the following conditions for at least 48 hours before, during and after installation:

- Site Temperature: 15.5°C - 29.5°C
- Floor Temperature:  $\geq 10^{\circ}\text{C}$
- Site Humidity: 40% - 65%
- Concrete Alkalinity: 5 - 9
- Concrete Moisture:  $\leq 8\%$

Pre-installation moisture and alkalinity tests should be performed by a qualified independent testing consultant. Advance Flooring will not be responsible for any failures or damage arising from high moisture, alkalinity, acidity or other subfloor conditions.

### Floor Preparation

The substrate must be structurally sound, clean, level and dry, free from dust, dirt, oil, grease, paint, curing agents, adhesives and any other substances that may affect adhesion.

For raised access flooring, panels must be smooth, level, secure and free of materials that could impact adhesive bonding. Carpet tiles should be installed offset from access panel seams, and gaps between panels should not exceed 1.6mm.

### Carpet Tile Preparation

While Advance Flooring guarantees premium quality, we recommend inspecting the tiles for any damage or defects and verifying that the product, colour, dimensions and quantity match your order. Verify the correct quantity and installation method. Please note that we will not cover costs associated with the replacement or repair of visibly damaged or defective tiles once installed.

Store carpet tiles flat and protect them from soil, dust, moisture and contaminants. Stacked cartons should not exceed five boxes if overlapped for extended periods.

Remove all carpet tiles from their cartons and allow them to acclimate to the site temperature for 48 hours before installation.

### Floor Heating

Carpet tiles can be installed over underfloor heating systems. After installation, wait 48 hours before activating the heating system, and never exceed a maximum temperature of 28°C.

### Protecting Tiles During Construction

If the tiles are installed in a construction area, protect them from dirt and moisture. Whenever possible, keep covered until construction is complete.

We are here to help you, if you have any questions or require further clarification please contact us.

# Installation Instructions

## Carpet Tiles & Planks

2/4

### Adhesive

Carpet tiles can be installed using an anti-slip or semi-permanent adhesive that offers a permanent, non-hardening sticky effect, allowing for easy movement and removal when necessary.

We recommend using a solvent-free, environmentally friendly adhesive with a full spread application. Ensure proper ventilation during adhesive application and allow the adhesive to dry completely before installing the carpet tiles; installing onto wet adhesive can create a permanent bond and may cause bubbling.

While tiles can be laid without adhesive, this is not recommended. For high-traffic areas such as doorways, offices, and educational environments, we strongly suggest using a tackifier adhesive. Avoid using solvents (such as white spirits or petrol), as they can damage the colour.

### Recommended Adhesives

- Strongbond 65 (recommended application with a roller) – supplied by Look Floors.
- PS66 for floor installation, UZIN WK222 for wall installation, and Giltgrip 88 for entrance matting – supplied by Gilledge.
- Ultrabond Eco Tack – supplied by Mapei.
- Polymer 999 PS – supplied by Gilt Edge Industries Ltd.
- Mapei Ultrabond Eco Fix – also recommended.

### Installation Methods

#### Pile Direction

Each tile has an arrow on the back indicating the pile direction. For certain collections and patterns, it's essential to consider this direction to achieve the desired effect. The installation method for each pattern is detailed on the technical data sheet. The four pattern types are:

- **Monolithic:** For a uniform appearance.
- **Quarter Turn:** Creates a checkerboard pattern.
- **Brick:** Arranges tiles in horizontal rows.
- **Ashlar:** Arranges tiles in vertical rows.

- 50\*50cm tile installation methods

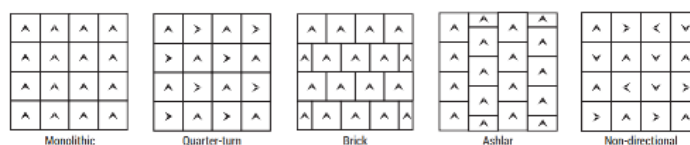

- 25\*100cm tile installation methods

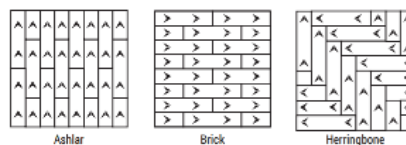

- 50\*100cm tile installation methods

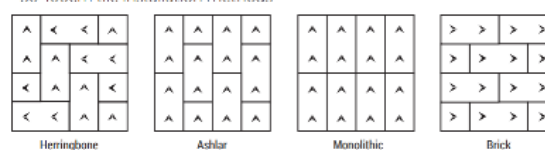

We are here to help you, if you have any questions or require further clarification please contact us.

# Installation Instructions

## Carpet Tiles & Planks

3/4

### Floor Layout

Begin by creating a diagram with exact measurements of the areas where the carpet will be installed. It's advisable to locate seams in low-traffic areas and mark all windows, doors, furniture and unusual angles. Divide the room into four quadrants and snap a chalk line to ensure the quadrants meet at right angles. Use the 3-4-5 triangle method to verify that the first line is perpendicular to the second. Measure the distance from each centre line to its parallel wall to determine how many tiles will be needed.

### Starting Point

Once the layout is established, start laying tiles with a full tile positioned at the doorway, continuing towards the centre of the room in parallel with the main wall (see diagram below). Ensure that no pile material is trapped between the tiles and apply firm pressure when butting the tiles together for a neat fit.

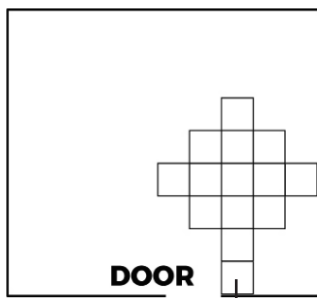

### Carpet Installation

Start from the intersection point in the centre of the floor. Install tiles in one quadrant using the chalk lines as guidelines. Fill the area between the chalk lines using the stair-step method, continuing in a pyramid pattern from the centre. Ensure tiles are properly aligned at the edges during installation. Fit the tiles tightly by sliding them together and pressing them into the adhesive.

As a general rule, avoid installing the same product from different batches in a continuous space unless acceptable batch differences have been confirmed.

### Cutting Carpet Tiles

Always cut tiles from the back. Use one tile as a reference and score a line on the back of the tile to be cut. Cut along this line, taking care not to cut through the installed tile below. Secure cut or partial tiles with releasable adhesive or double-sided tape. Ensure that the size of the cut tile is at least half the size of a standard carpet tile for proper security.

### Finishing the Edges

To finish the edges of your carpet tiles, start by placing the tile to be cut on top of the last laid tile. Next, slide a third tile against the wall to establish a reference. Cut the tile along the edge where it meets the wall, then position the cut tile against the wall for a snug fit. This method ensures a precise and clean edge.

We are here to help you, if you have any questions or require further clarification please contact us.

+64 9 634 4455 / sales@advanceflooring.co.nz / advanceflooring.co.nz

 Advance

# Installation Instructions

## Carpet Tiles & Planks

4/4

### Post-Installation Care

#### Initial Cleaning

We recommend performing a thorough carpet cleaning after installation. For more details, please refer to the Advance Flooring Maintenance Instructions.

#### Ventilation and Temperature

Keep the room well-ventilated and use an air exchanger if necessary. For best results, maintain temperatures between 15.5°C and 29.5°C, and ensure that site humidity does not fall below 40%.

#### Moving Heavy Objects

Place plywood over the carpet when moving heavy items to prevent damage.

#### Protection During Construction

Use non-staining building material paper on the carpet tiles for protection during additional construction activities. Avoid using plastic sheeting, as it can trap moisture.

#### Chair Protection

We recommend the use of protective chair mats under chairs and castors to prevent excessive wear on the carpet surface.

### Product Quality and Warranty

Advance Flooring is responsible for the product's quality as outlined in the technical data sheet. We will not be liable for improper installation, installation of visibly defective tiles, or incorrect adhesive use. The product is covered under warranty only when it is used and maintained correctly.

We are here to help you, if you have any questions or require further clarification please contact us.

+64 9 634 4455 / sales@advanceflooring.co.nz / advanceflooring.co.nz

The logo for Advance Flooring Systems Ltd, featuring a stylized wing-like graphic to the left of the word "Advance" in a bold, sans-serif font.