

MASONS
Designed Smart, Built Tough.

75mm Enviro Panel Floor details

MASONS NZ LIMITED | 0800 522 533 | info@mpb.co.nz | www.mpb.co.nz

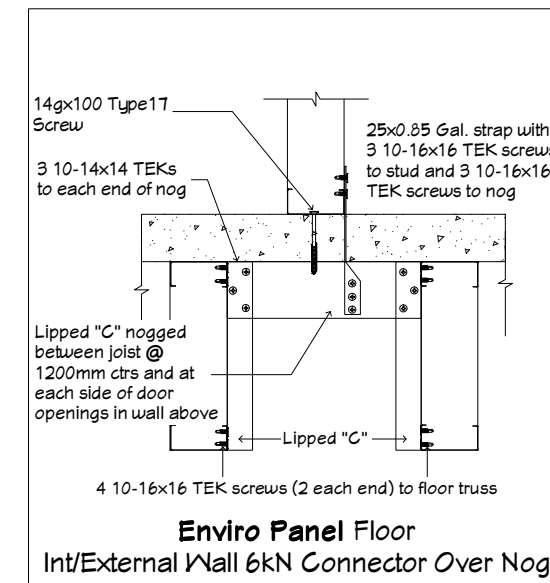
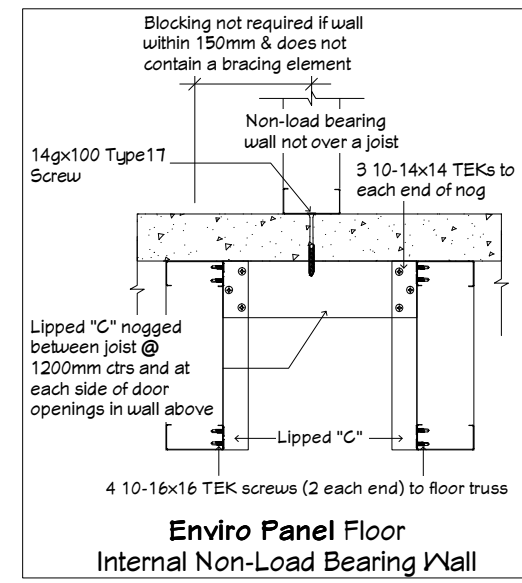
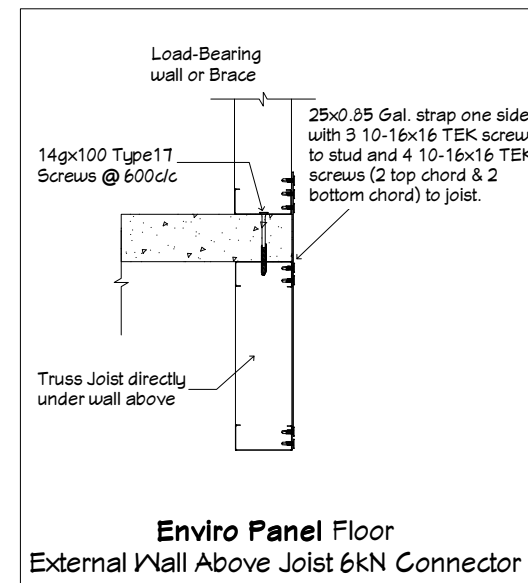
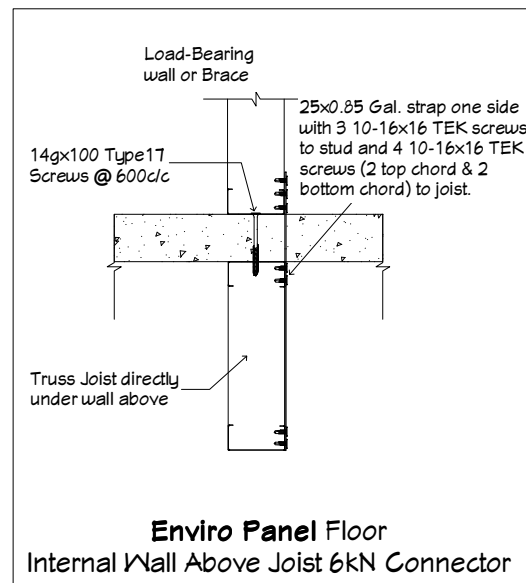
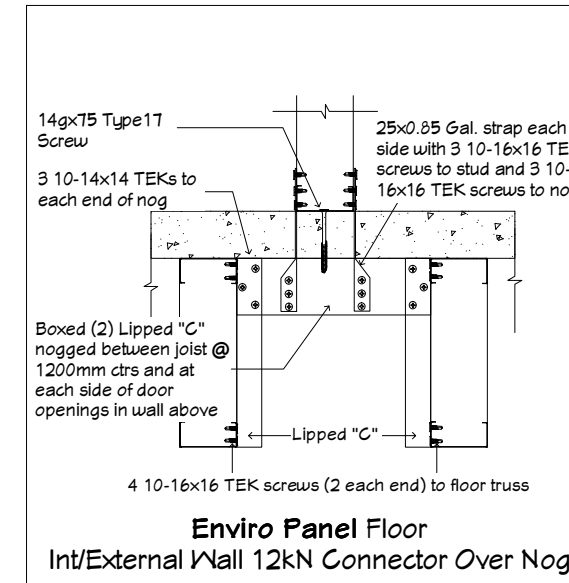
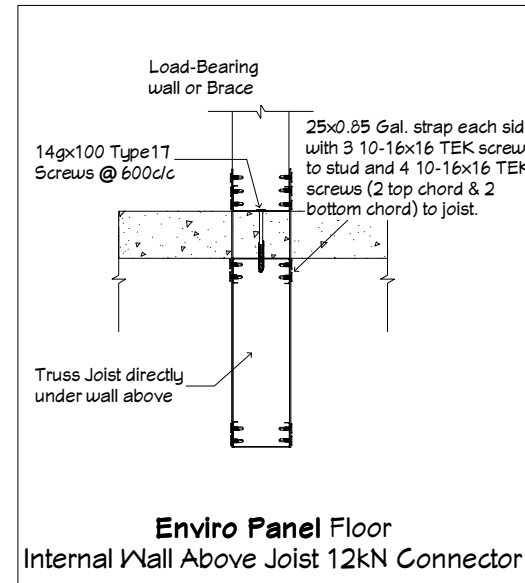
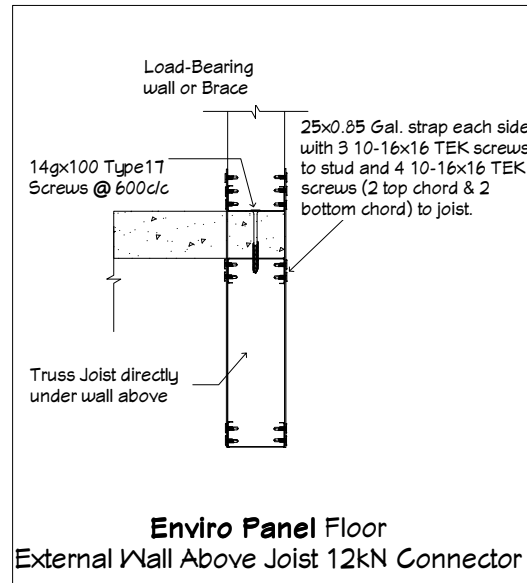

NOTES:

- For 1.5 kPa floor live loads, floor joists may be selected from the 2 kPa live load floor joist tables. For 2 kPa floor live loads, floor joists may be selected from 3 kPa live load floor joist tables. Alternatively floor joists may be specifically designed for additional loads from Enviro Floor Panel (self weight 0.3kPa)
- Fixing 75mm Enviro Floor Panel
- Alternative 14gx100 screws may be substituted for Type 17 screws
- Provide fixings at 150mm centres to perimeter of floor and around openings
- Floor adhesive to be Bostik 'Safe Stud' or Sika 'Nailbond Premium'. Application, primers where required and preparation to be strictly in accordance with manufactures specification and requirements.



75mm Enviro Panel Floor details
MASONS NZ LIMITED | 0800 522 533 | info@mpb.co.nz | www.mpb.co.nz