

PEF ROD P.E.F. FOAM BACKER  
**SPECIFICATION  
GUIDE**



**MASONS**  
Designed Smart, Built Tough.

V2.0 March 2024

## 1. GENERAL

<b>1.1 PRODUCT DESCRIPTION</b>	Masons™ PEF Rod is a cylindrical flexible closed cell polyethylene material, available in various diameters from 6mm to 50mm. Masons™ PEF Rod is suitable for domestic and commercial applications where gaps need to be sealed in conjunction with sealant or chalking compounds.
<b>1.2 PHYSICAL PROPERTIES</b>	<ul style="list-style-type: none"><li>› Type: Closed cell polyethylene foam.</li><li>› Compliance: complies to ASTM standards as a P.E.F. Backing Rod</li><li>› Material: Extruded Polyethylene foam is CFC free and non toxic</li><li>› Chemical Resistance: Unaffected by most chemicals</li><li>› Temperature Range: -40°C to 70°C</li><li>› Water Resistance: No water absorption</li><li>› Colour: White</li></ul>
<b>1.3 COMPATIBILITY</b>	Masons™ PEF Rod provides the following functions: <ul style="list-style-type: none"><li>› Limits the amount and depth of the sealant applied into the joint.</li><li>› Acts as a bond break to allow joint movement without undue stress to sealant.</li><li>› Acts as a barrier to the flow of sealant through a joint.</li><li>› Will assist in providing an around the window frame and penetrations through walls.</li><li>› For use with pre-cast concrete slabs and joints between brick and masonry.</li></ul>
<b>1.4 STORAGE</b>	Masons™ PEF Rod should be kept clean and dry during installation.



1.5 PRODUCTS	DIAMETER	ROLL LENGTH	MASONS CODE
	6mm	20m	Air Tight6X20
	6mm	50m	Air Tight6X50
	8mm	20m	Air Tight8X20
	8mm	50m	Air Tight8X50
	10mm	20m	Air Tight10X20
	10mm	50m	Air Tight10X50
	13mm	20m	Air Tight13X20
	13mm	50m	Air Tight13X50
	15mm	20m	Air Tight15X20
	15mm	50m	Air Tight15X50
	20mm	20m	Air Tight20X20
	25mm	10m	Air Tight25X10
	30mm	10m	Air Tight30X10
	40mm	10m	Air Tight40X10
	50mm	5m	Air Tight50X5

**1.6 INSTALLATION**

Masons™ PEF Rod is suitable for domestic and commercial applications where gaps need to be sealed in conjunction with sealant or chalking compounds.

- Always allow PEF Rod to be 25-30% larger than the width of the gap requiring filling.
- Ensure that the rod is firmly in place.

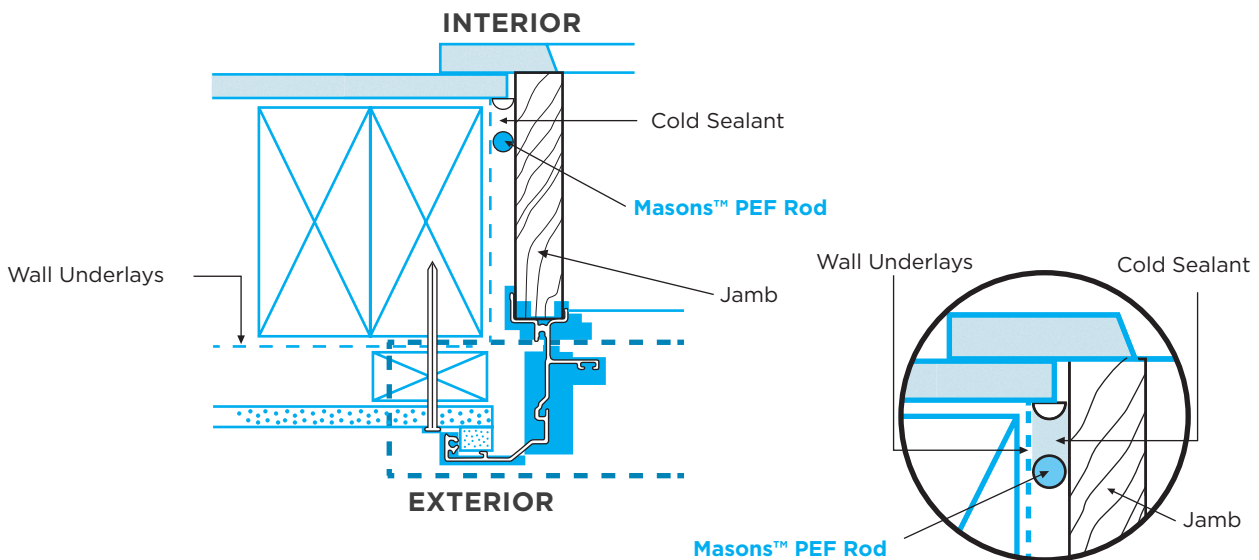

- Cut the PEF Rod to the required length and press the into the gap with a blunt tool to provide an even depth, avoid stretching and twisting the PEF Rod.

Masons™ PEF Rod is not intended in areas exposed to sunlight.



---

## 1.6 DURABILITY

Masons™ PEF Rod will meet the performance requirements of NZBC Clauses B2, Durability (B2.3.1[b] 15 years), E2 External Moisture E2.3.2, F2 Hazardous Building Materials F2.3.1, providing:

- The rod is not damaged
  - PEF Rod is installed according to the above installation guide
  - PEF Rod is not exposed to sunlight for prolonged periods
-