

Rev.	Description	Date	By	Rev.	Description	Date	By
A	BUILDING CONSENT	26.05.11	MH				

Rev.	Description	Date	By

INDY O&A SYSTEM
 REASON FOR ISSUE
 BUILDING CONSENT
 AUTHORIZATION
 BY:
 VESPER PITCHER
 LATEST AMENDMENT

Norman Disney & Young
 CONSULTING ENGINEERS
 101 CUSTON STREET
 29 CUSTON STREET WEST
 AUCKLAND, NEW ZEALAND
 TELEPHONE: +64 9 379 8688
 FACSIMILE: +64 9 379 8687
 URL: www.ndy.co.nz
 HOKIANG DESIGN & CONSTRUCTION LIMITED
 101 CUSTON STREET
 29 CUSTON STREET WEST
 AUCKLAND, NEW ZEALAND
 TELEPHONE: +64 9 379 8688
 FACSIMILE: +64 9 379 8687
 URL: www.ndy.co.nz

Project: **ADDIDAS MUSEUM AUSTRALIS NATHAN BUILDING**
 Title: **MECHANICAL SERVICES**
 Scale: 1:100 @ A1
 Date: 16.05.11
 Drawn: MH
 Designed: AB
 Project No: 91216-004
 CAD File: MGR
 Revision: A
 Drawing No: **M-0G-001**

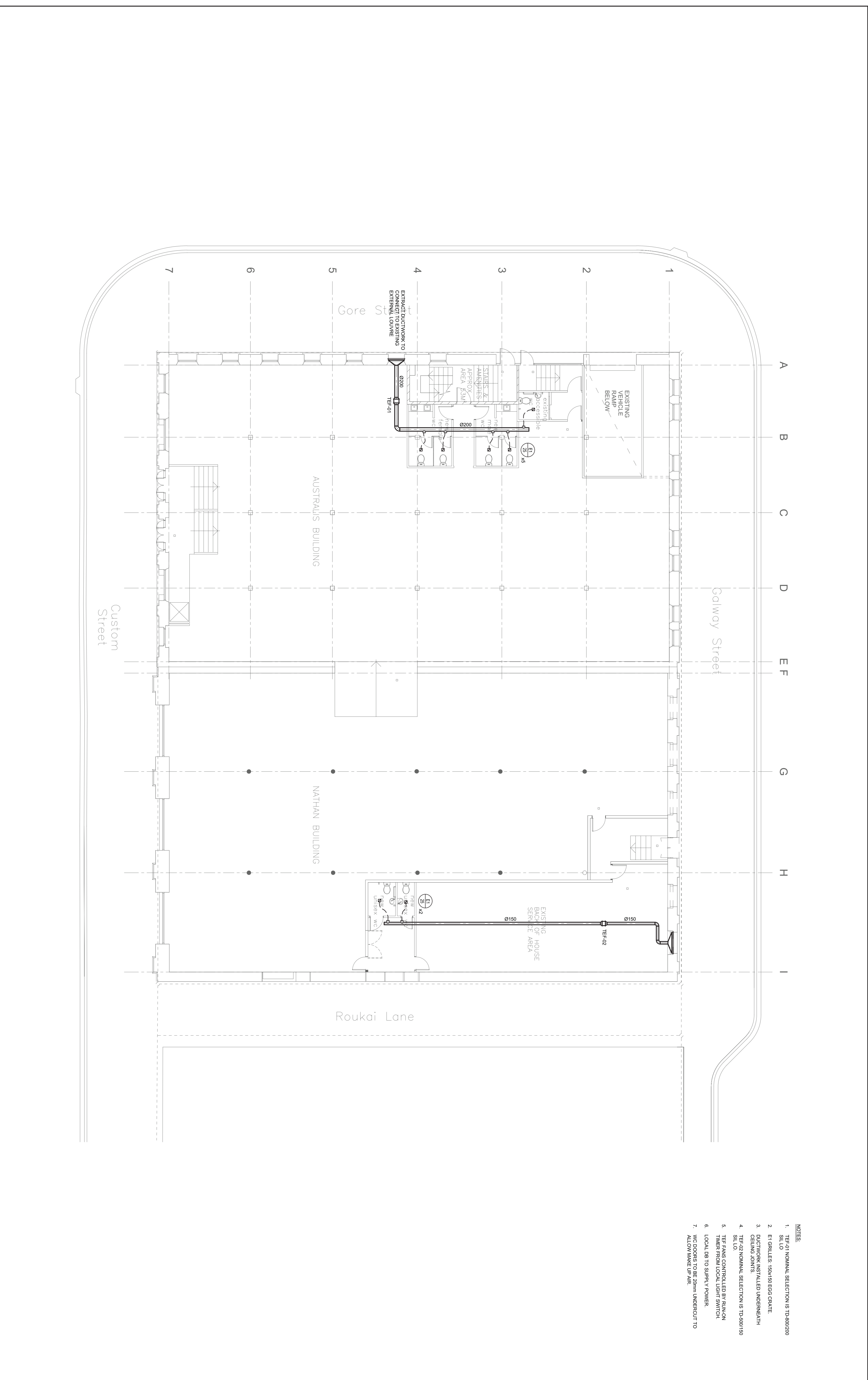

- NOTES:
- TEF-Q1 NOMINAL SELECTION IS TD-800/200 SIL LO
 - E1 GRILLES, 150x150 EGOS GRATE
 - DUCTWORK INSTALLED UNDERNEATH CEILING JOINTS
 - TEF-Q2 NOMINAL SELECTION IS TD-500/150 SIL LO
 - TEF FANS CONTROLLED BY RUNCN TIMER FROM LOCAL LIGHT SWITCH
 - LOCAL DB TO SUPPLY POWER
 - WC DOORS TO BE 20mm UNDERCUT TO ALLOW MAKE UP AIR